

**EMI-1150-23F**

**ORGANIZATIONAL AND DIRECT SUPPORT  
MAINTENANCE REPAIR PARTS MANUAL FOR THE  
SURROGATE FAST ATTACK VEHICLE (SFAV)**

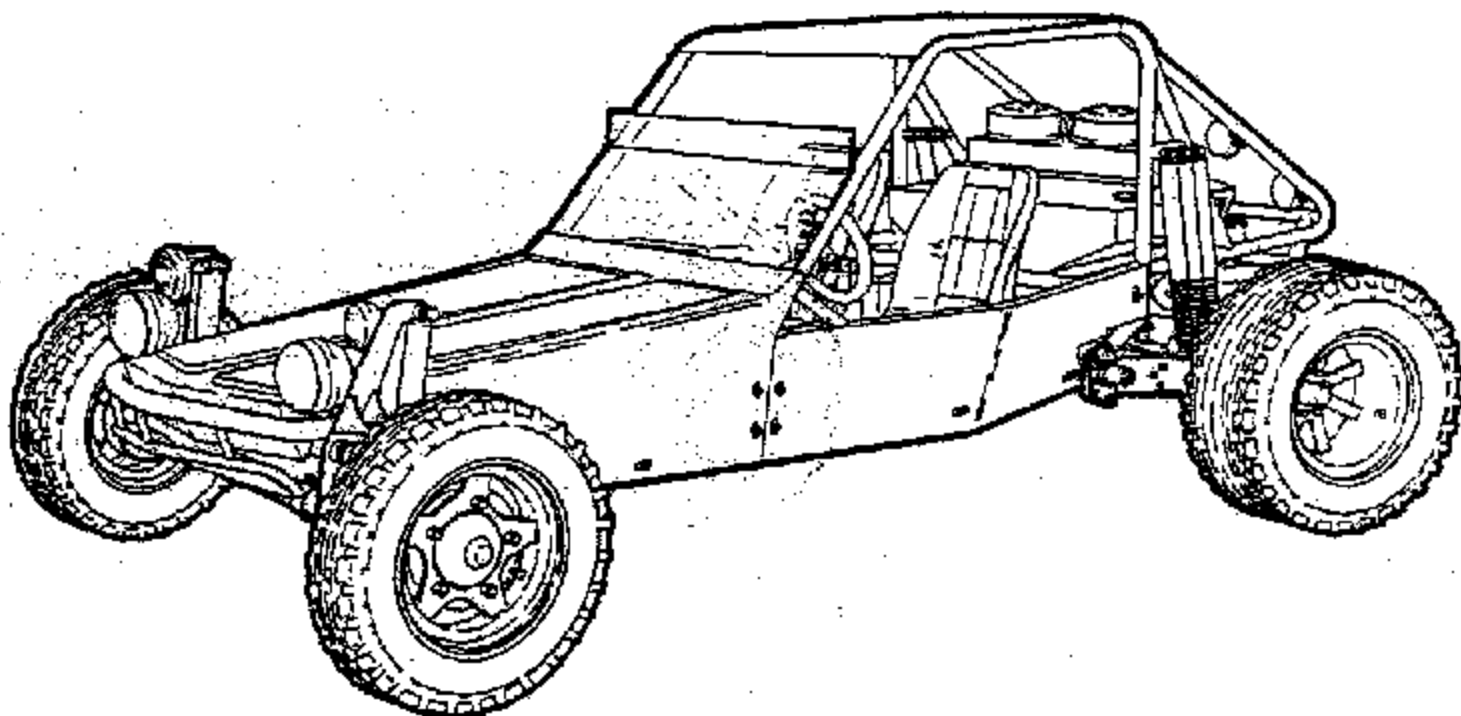

**CHENOWETH**  
RACING PRODUCTS, INC.

943 Vernon Way  
El Cajon, California 92020  
619/449-7100

**15 OCTOBER 1982**

ORGANIZATIONAL AND DIRECT SUPPORT MAINTENANCE  
REPAIR PARTS MANUAL  
FOR  
SURREGATE FAST ATTACK VEHICLE (SFAV)

Current as of 15 OCTOBER 1982

		Figure	Page
Section I	INTRODUCTION AND SPECIAL INFORMATION		1-1
Section II	REPAIR PARTS LIST		2-1
Group 01	ENGINE		
	0100 ENGINE ASSEMBLY	1	2-2
	0106 ENGINE LUBRICATION SYSTEM	2	2-4
Group 02	CLUTCH		
	0200 CLUTCH ASSEMBLY	3	2-6
	0207 HYDRAULIC CLUTCH SYSTEM	4	2-8
Group 03	FUEL SYSTEM		
	0301 CARBURETOR	5	2-10
	0302 FUEL PUMP	6	2-12
	0304 AIR CLEANER	7	2-14
	0306 FUEL TANK	8	2-16
	0312 PEDAL AND THROTTLE CABLE	9	2-18
Group 04	EXHAUST SYSTEM		
	0401 MUFFLER AND EXHAUST PIPE	10	2-20
Group 06	ELECTRICAL SYSTEM		
	0601 ALTERNATOR/REGULATOR	11	2-22
	0603 STARTING MOTOR	12	2-24
	0605 IGNITION COMPONENTS	13	2-26
	0607 INSTRUMENTS AND CONTROL PANEL	14	2-28
	0609 LIGHTS	15	2-30
	0612 BATTERY	16	2-32
Group 07	TRANSMISSION		
	0700 TRANSMISSION ASSEMBLY	17	2-34
	0705 TRANSMISSION LINKAGE	18	2-36

		Figure	Page
Group 08	FINAL DRIVE		
	0807 FINAL DRIVE ASSEMBLY	19	2-38
Group 12	BRAKES		
	1201 CUTTING BRAKE	20	2-40
	1202 BRAKE SHOES	21	2-42
	1204 BRAKE HYDRAULIC SYSTEM	22	2-44
Group 13	WHEELS		
	1313 WHEEL COMPONENTS	23	2-48
	1313 TIRES, TUBES AND WHEELS	24	2-50
Group 14	STEERING		
	1401 MECHANICAL STEERING ASSEMBLY	25	2-52
Group 15	FRAME		
	1501 FRAME COMPONENTS	26	2-54
Group 16	SHOCK ABSORBERS		
	1604 SHOCKS	27	2-58
Group 18	BODY AND CAB		
	1801 BODY COMPONENTS	28	2-60
Section III	INDEX - PART NUMBER TO FIGURE AND ITEM NUMBER		3-1

## Section I. INTRODUCTION AND SPECIAL INFORMATION

## 1-1. Scope

This manual lists spares and repair parts required for performance of organizational and direct support maintenance of the Surrogate Fast Attack Vehicle (SFAV). It authorizes the requisitioning and issuance of spares and repair parts as indicated by the source and maintenance codes.

## 1-2. General Information

A list of spares and repair parts authorized for use in the performance of maintenance is included. The list also includes parts which must be removed for replacement of the authorized parts. Parts lists are in figure and item number sequence.

## 1-3. Explanation of Columns

a. Illustration. This column is divided as follows:

(1) Figure number. The number indicates the figure number of the illustration on which the item is shown.

(2) Item number. The item number is the number used to identify an item called out in the illustration.

b. Source, Maintenance, and Recoverability Codes. Source, maintenance, and recoverability (SMR) codes are as follows:

(1) Source Code. Source codes indicate the manner of acquiring support items for maintenance, repair, or overhaul of end items. Source codes are entered in the first and second positions of the Uniform SMR Code format as follows:

Code	Definition
PA	- Item procured and stocked for anticipated or known usage.
PB	- Item procured and stocked for insurance purpose because essentiality dictates that a minimum quantity be available in the supply system.
PE	- Support equipment procured and stocked for initial issue or outfitting to specified maintenance repair activities.
XA	- Item is not procured or stocked because the requirements for the item will result in the replacement of the next higher assembly.
XB	- Item is not procured or stocked. If not available through salvage, requisition.
XD	- A support item that is not stocked. When required, item will be procured through normal supply channels.

## NOTE

Cannibalization or salvage may be used as a source of supply for any items coded above except those coded XA.

(2) Maintenance Code. Maintenance codes are assigned to indicate the levels of maintenance authorized to USE and REPAIR support items. The maintenance codes are entered in the third and fourth positions of the Uniform SMR Code format as follows:

(a) The maintenance code entered in the third position will indicate the LOWEST maintenance level authorized to remove, replace, and use the support item. The maintenance code entered in the fourth position will indicate one of the following levels of maintenance:

Code	Application/Explanation
O	- Support item is removed, replaced, used at the Organizational Support level.
F	- Support item is removed, replaced, used at the Direct Support level.

(b) The maintenance code entered in the fourth position indicates whether the item is to be repaired and identifies the LOWEST maintenance level with the capability to perform complete repair (i.e., all authorized maintenance functions). This position will contain one of the following maintenance codes.

Code	Application/Explanation
O	- The LOWEST maintenance level capable of complete repair of the support item is the Organizational Support level.
F	- The LOWEST maintenance level capable of complete repair of the support item is the Direct Support level.
L	- Repair restricted to Specialized Repair Activity.
Z	- Nonrepairable. No repair is authorized.

(3) Recoverability Code. Recoverability codes are assigned to support items to indicate the disposition action on unserviceable items. The recoverability code is entered in the fifth position of the Uniform SME Code format as follows:

Recoverability Codes	Definition
F	- Repairable item. When uneconomically repairable, condemn and dispose at the Direct Support level.
L	- Repairable item. Repair, condemnation, and disposal not authorized below Specialized Repair Activity level.
Z	- Nonrepairable item. When unserviceable, condemn and dispose at the level indicated in position 3.

c. Part Number. Indicates the primary number used by the manufacturer which controls the design and characteristics of the item by means of its engineering drawings, specifications, standards, and inspection requirements to identify an item or range of items.

d. Federal Supply Code for Manufacturer. The Federal Supply Code for Manufacturer (FSCM) is a 5-digit numeric code which is used to identify the manufacturer, distributor, or Government agency, etc.

e. Description. Indicates the item name and, if required, a minimum description to identify the item.

f. Unit of Measure. The unit of measure (U/M) indicates the standard of the basic quantity of the listed item as used in performing the actual maintenance function. This measure is expressed by a two-character alphabetical abbreviation (e.g., ea, in, pr, etc).

g. Quantity Incorporated in Unit. Indicates the quantity of the item used in the breakout shown on the illustration figure. A "v" appearing in this column in lieu of a quantity indicates that no specific quantity is applicable, (e.g., shims, spacers, etc).

#### 1-4. Related Publications

The following publications pertain to the SFAV:

EM-1150-10	Operator's Manual for the Surrogate Fast Attack Vehicle (SFAV)
EM-1150-23	Shop Maintenance, Service and Repair Manual for the Surrogate Fast Attack Vehicle (SFAV)

Section II. REPAIR PARTS LIST



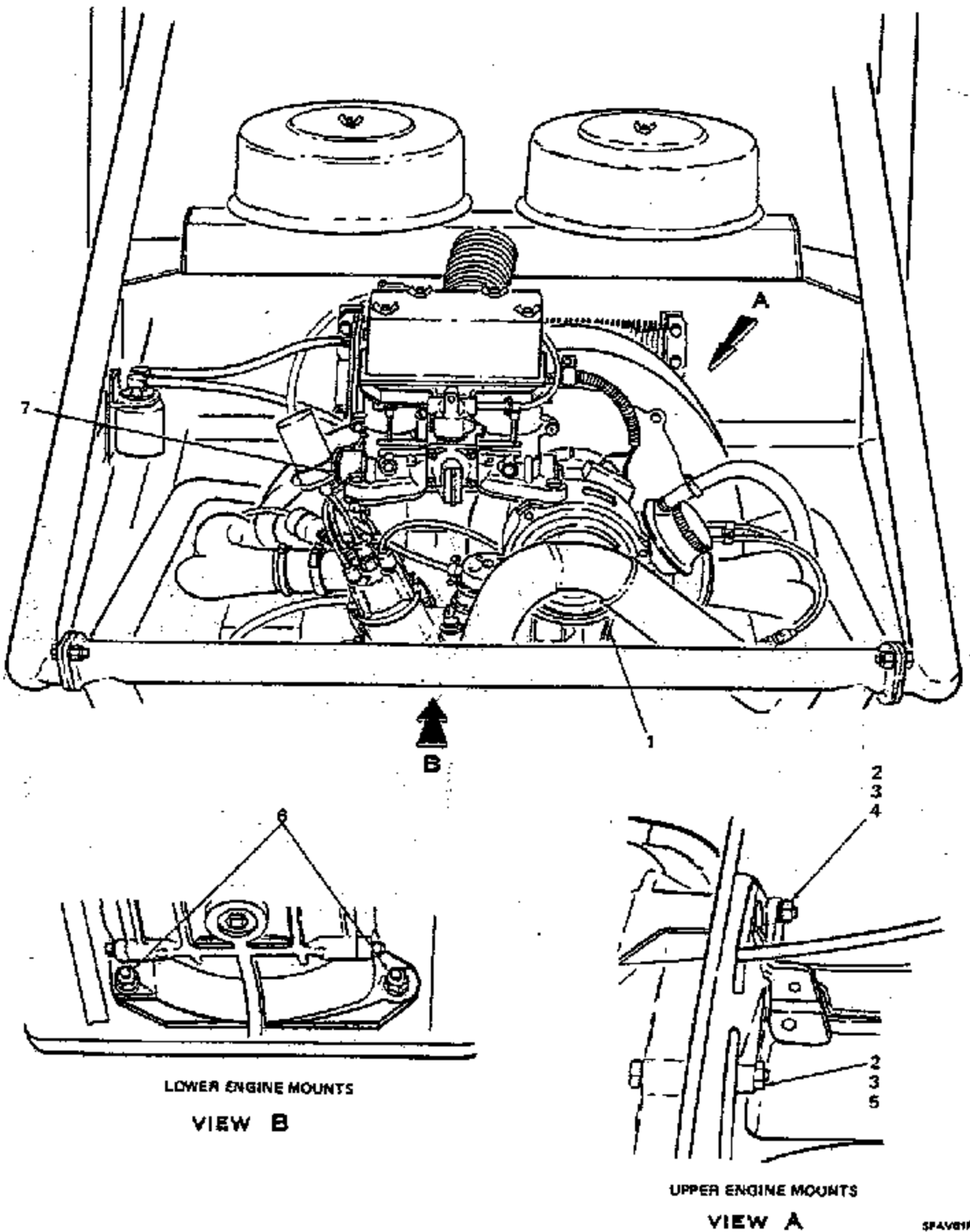

Figure 2-1. Engine Assembly

(1) ILLUSTRATION		(2)	(3)	(4)	(5)	(6)	(7)	(8)
(a) FIG NO.	(b) ITEM NO.	SMR CODE	NATIONAL STOCK NUMBER	PART NUMBER	FSCN	DESCRIPTION  USABLE ON CODE	U/M	QTY INC- IN UNIT
						GROUP 0100 - ENGINE ASSEMBLY		
1	1	PA02Z		1-1317	20418	BELT, ALTERNATOR DRIVE	EA	1
1	2	PAFZZ		COML	COML	NUT, 10MM X 150 PITCH	EA	2
1	3	PAFZZ		COML	COML	WASHER, FLAT: 10MM	EA	2
1	4	PAFZZ		COML	COML	BOLT, MACHINE: 10MM X 130MM X 150 PITCH	EA	1
1	5	PAFZZ		COML	COML	BOLT, MACHINE: 10MM X 100MM X 150 PITCH	EA	1
1	6	PAFZZ		COML	COML	NUT, SELF-LOCKING: 3/8	EA	2
1	7	PAFLI		1-1111	20418	ENGINE ASSEMBLY	EA	1

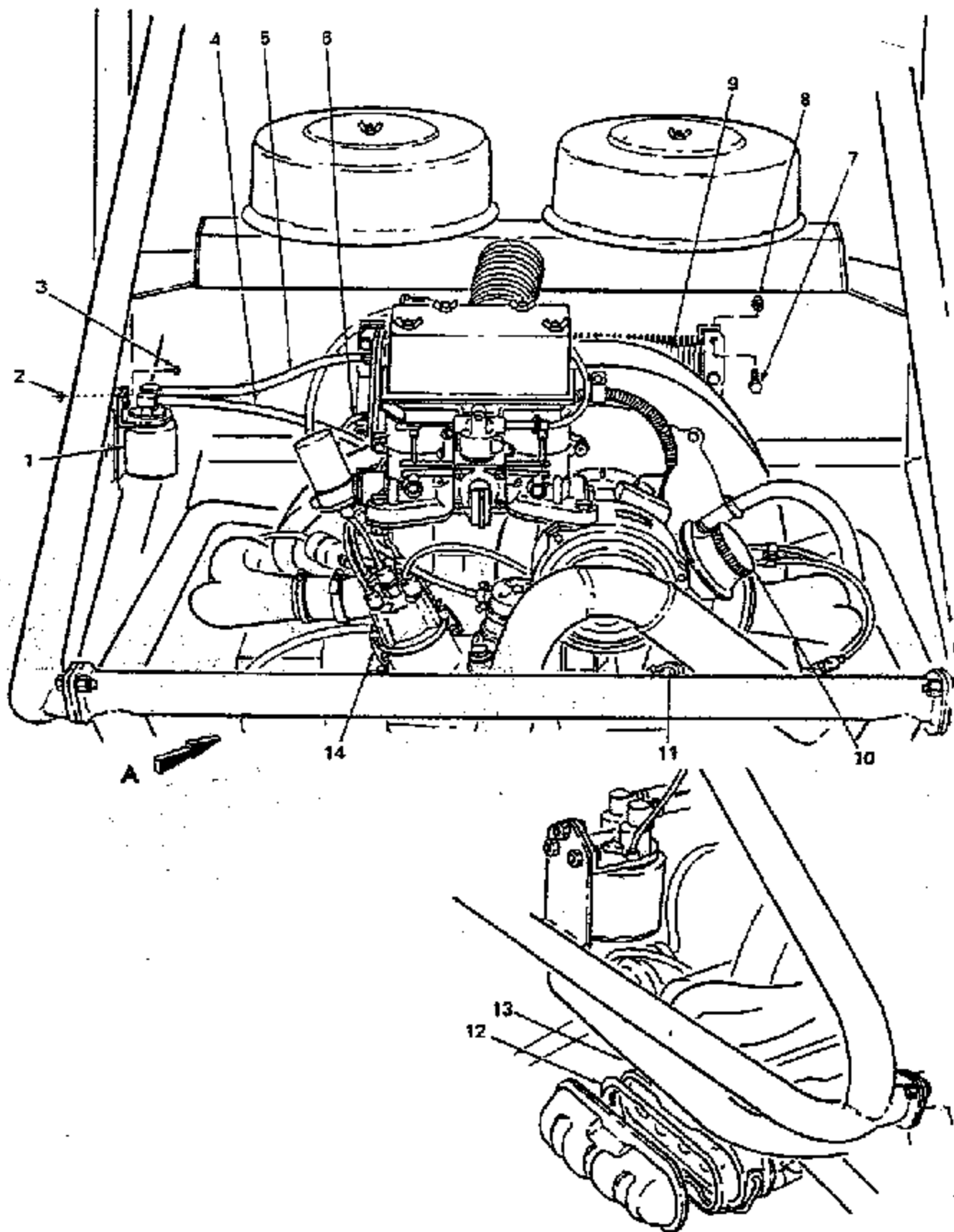
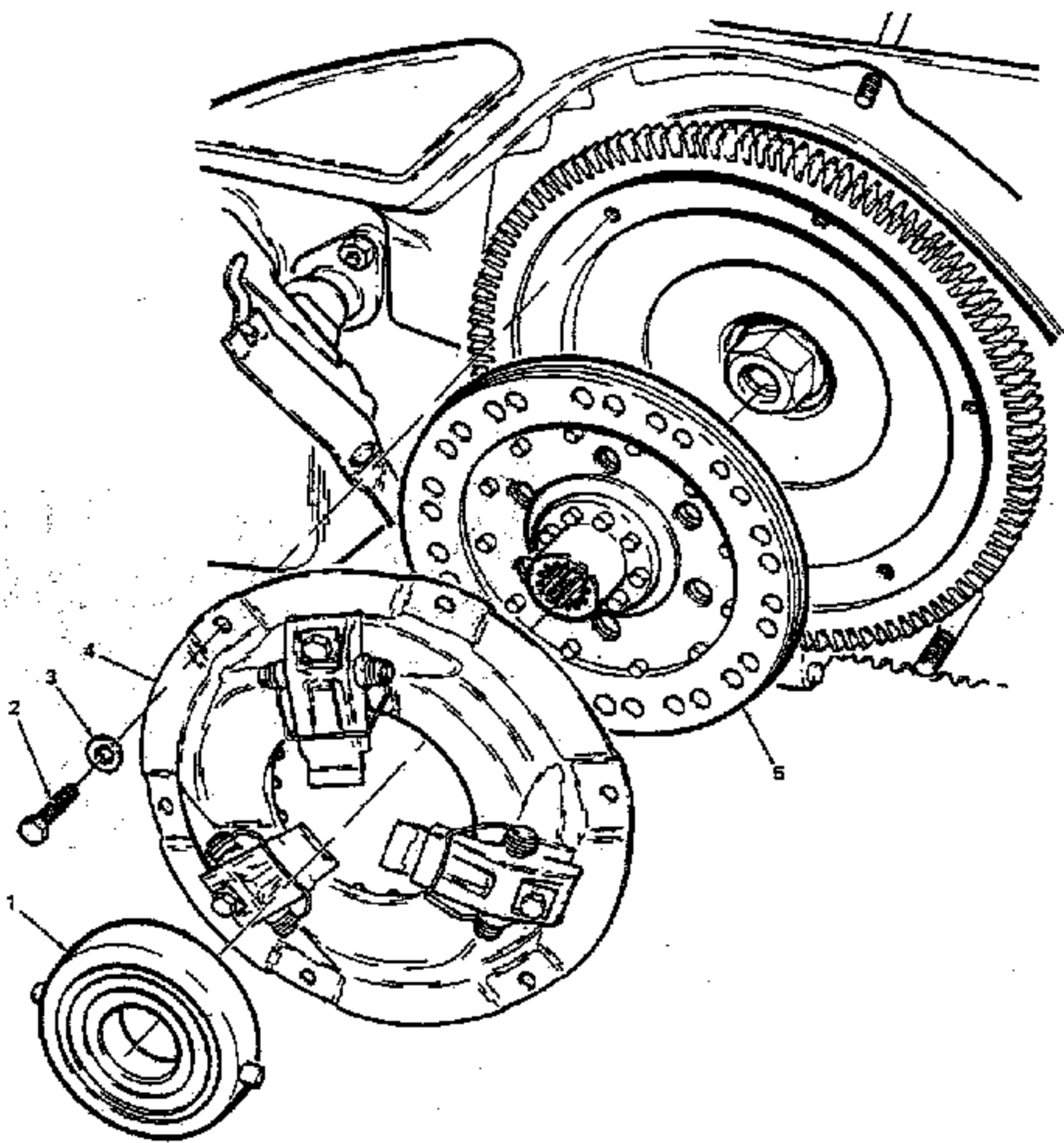

Figure 2-2. Engine Lubrication System.

SPAVEN

(1) ILLUSTRATION		(2)	(3)	(4)	(5)	(6)	(7)	(8)
(a) FIG NO.	(b) ITEM NO.	SMR CODE	NATIONAL STOCK NUMBER	PART NUMBER	FSCM	DESCRIPTION  USABLE ON CODE	U/M	QTY INC IN UNIT
2	1	PAOZZ		9-1139	20418	GROUP 0106 - ENGINE LUBRICATION		
						OIL FILTER, REMOTE	EA	1
2	2	PAOZZ		COML	COML	NUT, SELF-LOCKING: 5/16-18	EA	2
2	3	PADOZZ		COML	COML	BOLT, MACHINE: 5/16-18 x 1, GRADE 5	EA	2
2	4	PAOZZ		9-1360	20418	HOSE: 14-1/2"	EA	1
2	5	PAOZZ		9-1360	20418	HOSE: 11-1/2"	EA	1
2	6	PAOZZ		9-1360	20418	HOSE: 14-1/2"	EA	1
2	7	PAOZZ		COML	COML	NUT, SELF-LOCKING: 1/4-20	EA	4
2	8	PAOZZ		COML	COML	BOLT, MACHINE: 1/4-20 X 1	EA	4
2	9	PAOZZ		9-1140	20418	OIL COOLER ASSEMBLY	EA	1
2	10	PADOZZ		1-1314	20418	CAP, OIL FILLER	EA	1
2	11	PAOZZ		1-1355	20418	DIP STICK	EA	1
2	12	PAOZZ		1-1312	20418	CASKET, VALVE COVER	EA	2
2	13	PAOZZ		8-1306	20418	CYLINDER HEAD TEMPERATURE SENDING UNIT	EA	1
2	14	PAOZZ		8-1229	20418	OIL PRESSURE SENDING UNIT	EA	1



SPAVEN

Figure 2-3. Clutch Assembly



(1) ILLUSTRATION		(2)	(3)	(4)	(5)	(6)	(7)	(8)
(a) FIG NO.	(b) ITEM NO.	SMR CODE	NATIONAL STOCK NUMBER	PART NUMBER	FSCH	DESCRIPTION	U/M	QTY INC IN UNIT
						USABLE ON CODE		
3	1	PAFZZ		7-1302	20418	GROUP 0200 - CLUTCH ASSEMBLY		
						BEARING, CLUTCH RELEASE	EA	1
3	2	PAFZZ		COML	COML	BOLT, MACHINE: 8MM X 20MM X 1.25 PITCH	EA	6
3	3	PAFZZ		COML	COML	WASHER, LOCK: 8MM	EA	6
3	4	PAFZZ		7-1301	20418	PLATE, PRESSURE, CLUTCH	EA	1
3	5	PAFZZ		7-1300	20418	DISC, CLUTCH	EA	1

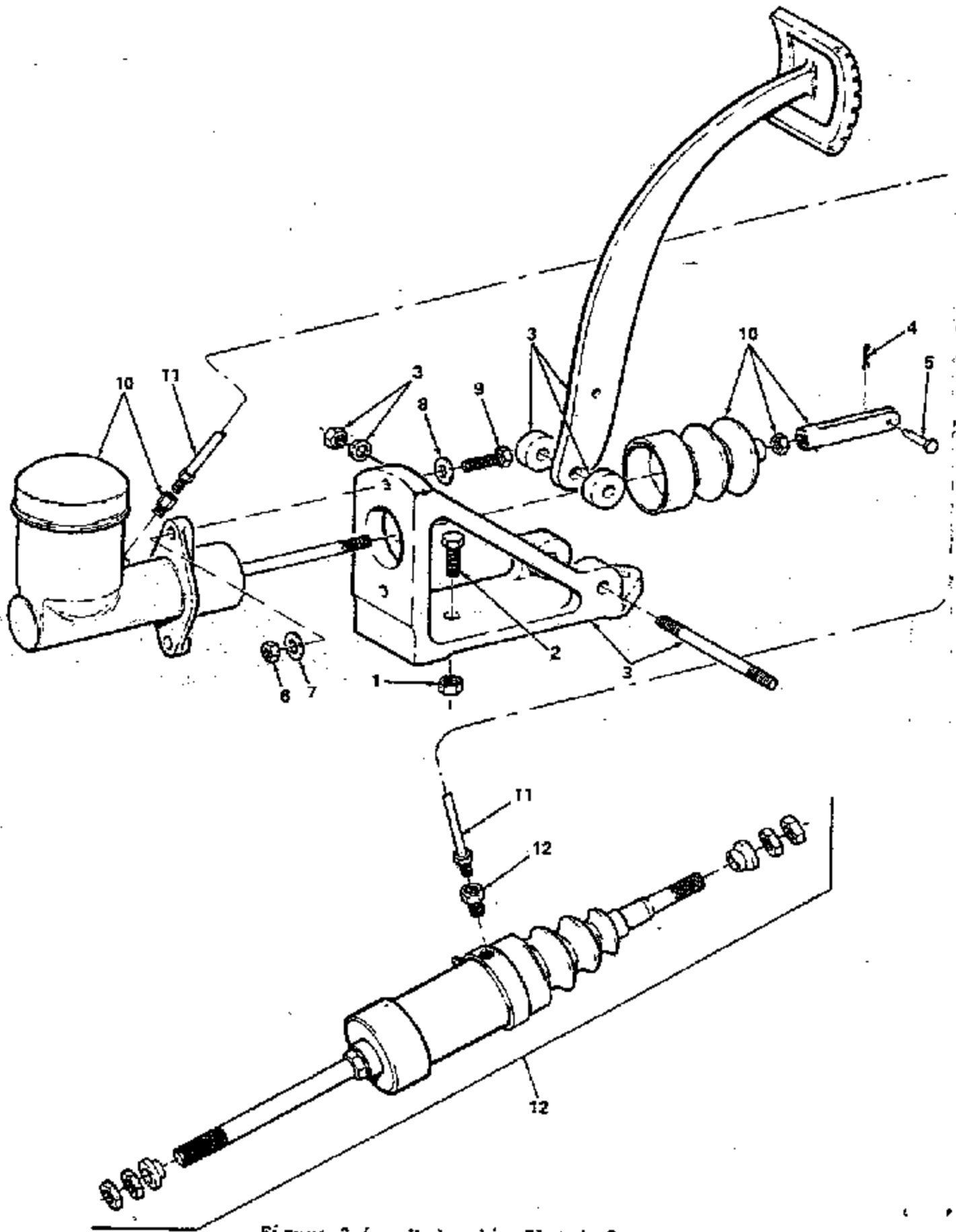

Figure 2-4. Hydraulic Clutch System



(1) ILLUSTRATION		(2)	(3)	(4)	(5)	(6)	(7)	(8)
(a) FIG NO.	(b) ITEM NO.	SMR CODE	NATIONAL STOCK NUMBER	PART NUMBER	FSCM	DESCRIPTION  USABLE QN CODE	U/M	QTY INC IN UNIT
						GROUP 0207 - HYDRAULIC CLUTCH SYSTEM		
4	1	PA02Z		COML	COML	NUT, SELF-LOCKING: 1/4-20	EA	2
4	2	PA02Z		COML	COML	BOLT, MACHINE: 1/4-20 X 1	EA	2
4	3	PA000		7-1197	20418	PEDAL ASSEMBLY, CLUTCH	EA	1
4	4	PA02Z		COML	COML	PIN, CUTTER: 5/4 X 3/64	EA	1
4	5	PA02Z		COML	COML	PIN, STRAIGHT, HEADED: 1/4 X 3/4	EA	1
4	6	PA02Z		COML	COML	NUT: 5/16-18	EA	2
4	7	PA02Z		COML	COML	WASHER, LOCK: 5/16	EA	2
4	8	PA02Z		COML	COML	WASHER, FLAT: 5/16	EA	2
4	9	PA02Z		COML	COML	BOLT, MACHINE: 5/16-18 X 1-1/4	EA	2
4	10	PA02Z		7-1320	20418	CYLINDER, CLUTCH MASTER	EA	1
4	11	PA02Z		7-1298	20418	TUBE ASSEMBLY	EA	1
4	12	PA02Z		7-1321	20418	CYLINDER, CLUTCH SLAVE	EA	1

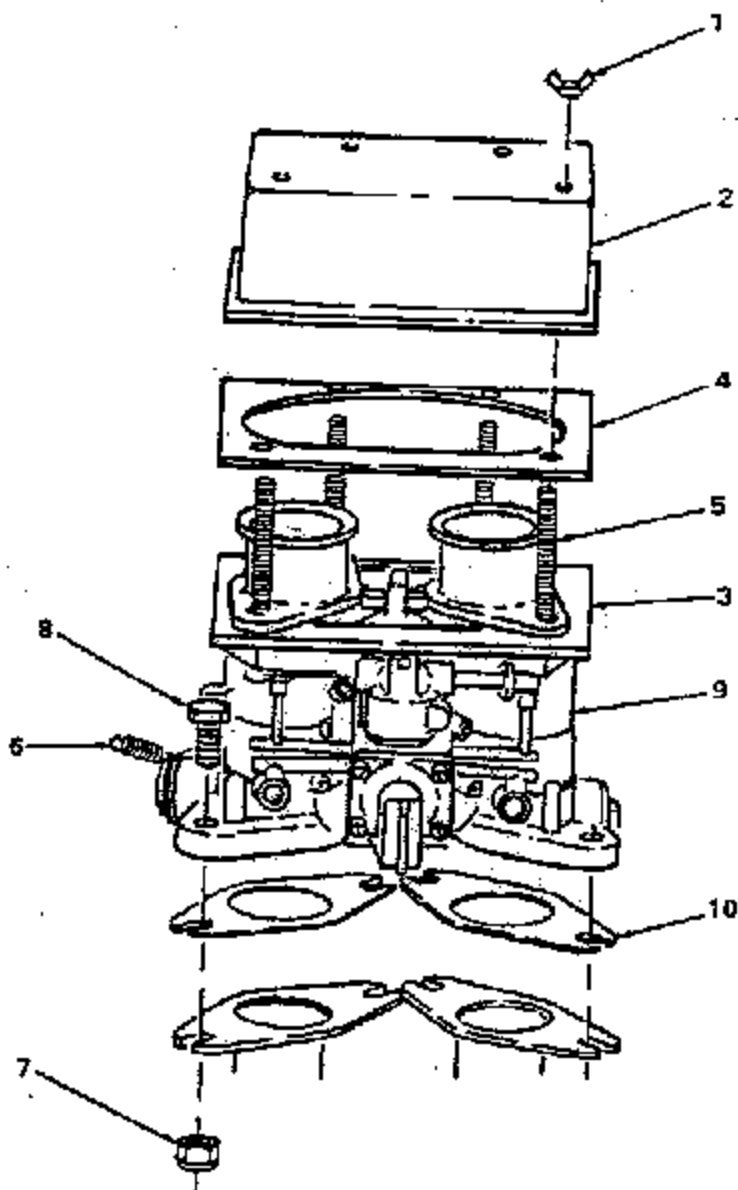

Figure 2-5. Carburetor

SFAV04P

(1) ILLUSTRATION		(2)	(3)	(4)	(5)	(6)	(7)	(8)
(a) FIG NO.	(b) ITEM NO.	SNR CODE	NATIONAL STOCK NUMBER	PART NUMBER	FSCN	DESCRIPTION  <i>USABLE ON CODE</i>	U/M	QTY INC IN UNIT
						GROUP 0301 - CARBURETOR		
5	1	PA02Z		9-1364	20418	WING NUT	EA	4
5	2	PA02Z		9-1348	20418	ADAPTER, CARBURETOR INTAKE	EA	1
5	3	PA02Z		9-1361	20418	PLATE, ADAPTER	EA	1
5	4	PA02Z		9-1362	20418	SEAL	EA	1
5	5	PA02Z		9-1363	20418	STUD, THREADED	EA	4
5	6	PA02Z		1-1113	20418	SPRING, THROTTLE	EA	1
5	7	PA02Z		COHL	COHL	NUT, SELF-LOCKING: 5/16	EA	4
5	8	PA02Z		COHL	COHL	BOLT, MACHINE: 5/16 X 1-1/4	EA	4
5	9	PA0FL		1-1303	20418	CARBURETOR	EA	1
5	10	PA02Z		1-1387	20418	GASKET	EA	1
5	11	PA02Z		1-1304	20418	KIT, CARBURETOR REBUILD (NOT ILLUSTRATED)	EA	1

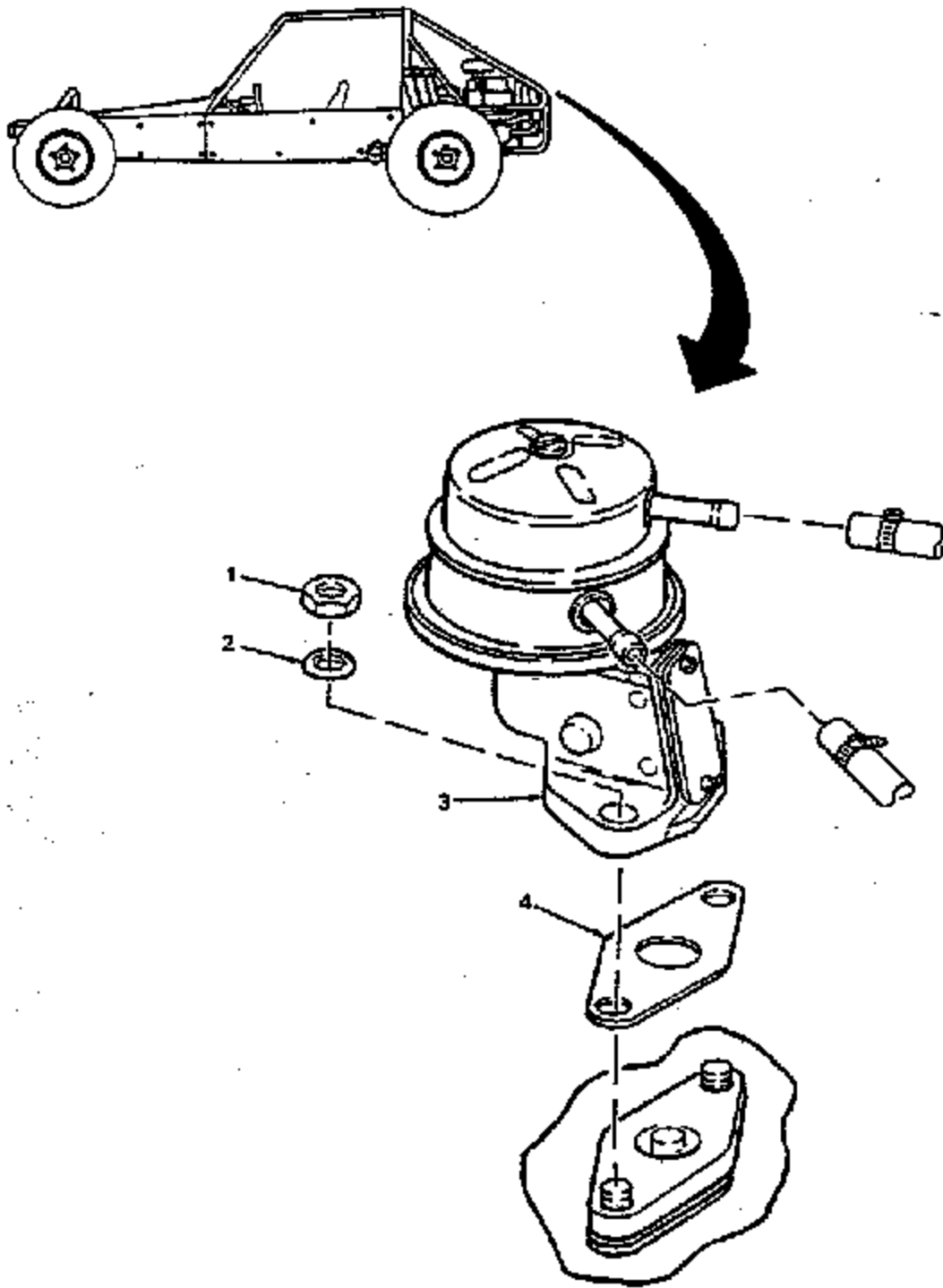

Figure 2-6. Fuel Pump

SFAV05W

(1) ILLUSTRATION		(2)	(3)	(4)	(5)	(6)	(7)	(8)
(a) FIG NO.	(b) ITEM NO.	SMR CODE	NATIONAL STOCK NUMBER	PART NUMBER	FSC#	DESCRIPTION  USABLE ON CODE	U/M	QTY INC IN UNIT
6	1	PA022		COML	COML	GROUP D302 - FUEL PUMP		
						NUT: 6MM-1.25 PITCH	EA	2
6	2	PA022		COML	COML	WASHER, LOCK: 6MM	EA	2
6	3	PA022		1-1305	20418	PUMP, FUEL	EA	1
6	4	PA022		1-1313	20418	GASKET, FUEL PUMP	EA	1

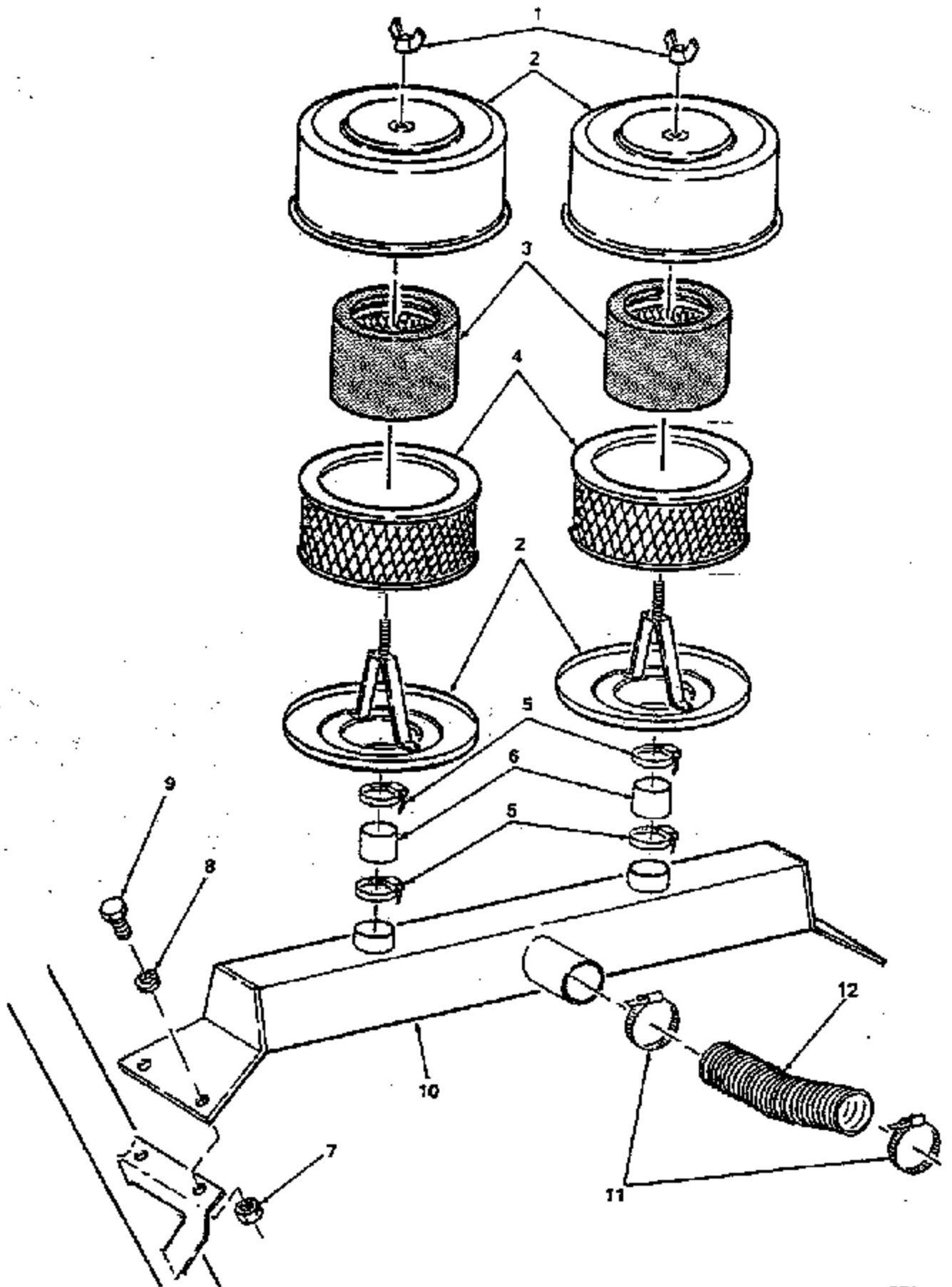

Figure 2-7. Air Cleaner

SPAV

(1) ILLUSTRATION		(2)	(3)	(4)	(5)	(6) DESCRIPTION
(a) FIG NO.	(b) ITEM NO.	SMR CODE	NATIONAL STOCK NUMBER	PART NUMBER	FSCM	USABLE ON CODE
						GROUP 0304 - AIR CLEANER
7	1	PA022		COML	COML	WING NUT: 1/4-20
7	2	PA022		9-1138	20418	FILTER ASSEMBLY, AIR
7	3	PA022		9-1365	20418	FILTER, AIR, RUBBER —
7	4	PA022		9-1318	20418	FILTER, AIR, PAPER
7	5	PA022		NO. 64	20418	CLAMP, HOSE
7	6	PA022		COML	COML	HOSE, RUBBER
7	7	PA022		COML	COML	NUT, SELF-LOCKING: 1/4-20
7	8	PA022		COML	COML	WASHER, FLAT: 1/4
7	9	PA022		COML	COML	BOLT, MACHINE: 1/4-20 x 3/4
7	10	PA022		9-1137	20418	LOG, AIR INTAKE
7	11	PA022		NO. 48	20418	CLAMP, HOSE
7	12	PA022		9-1138	20418	HOSE, FLEXIBLE

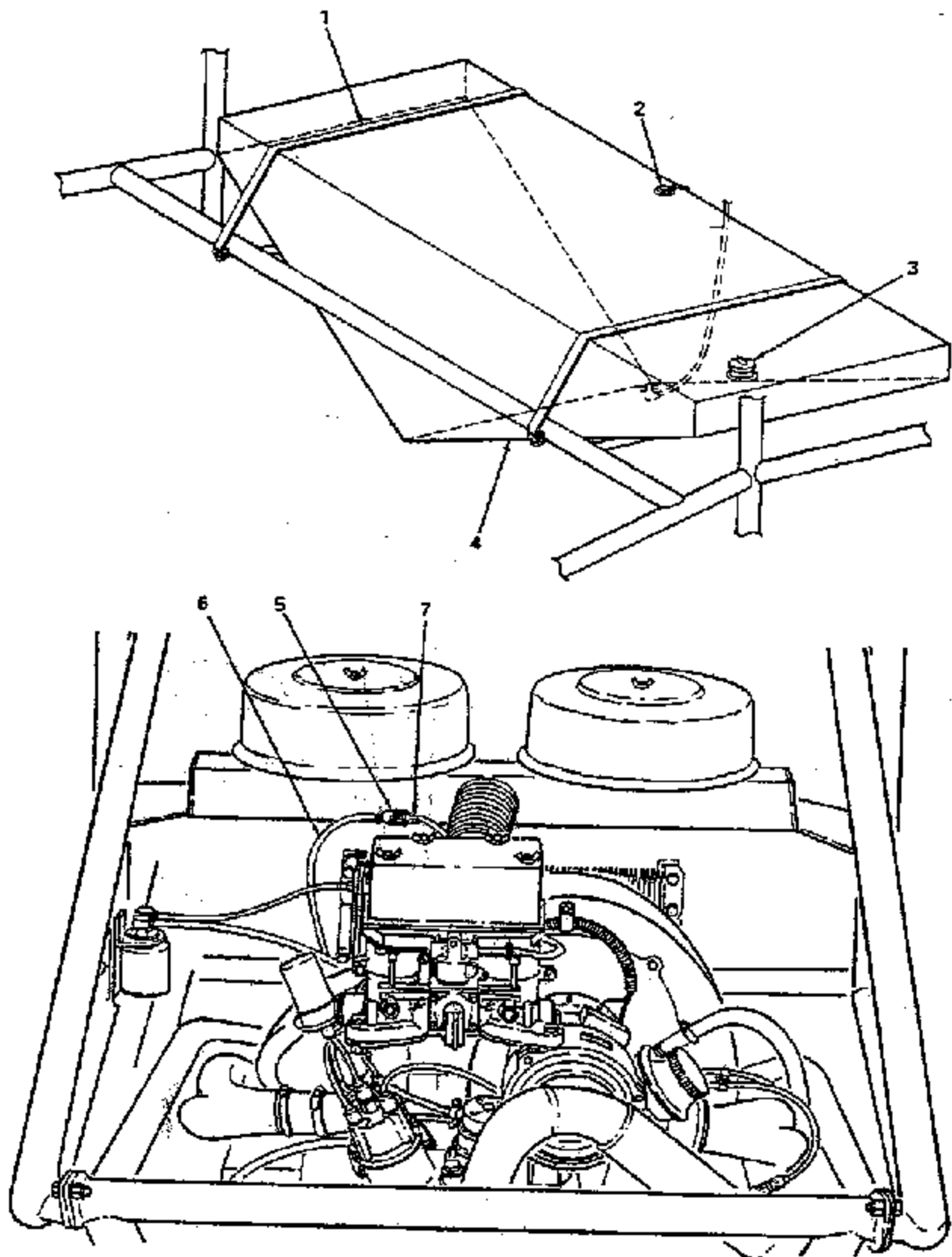
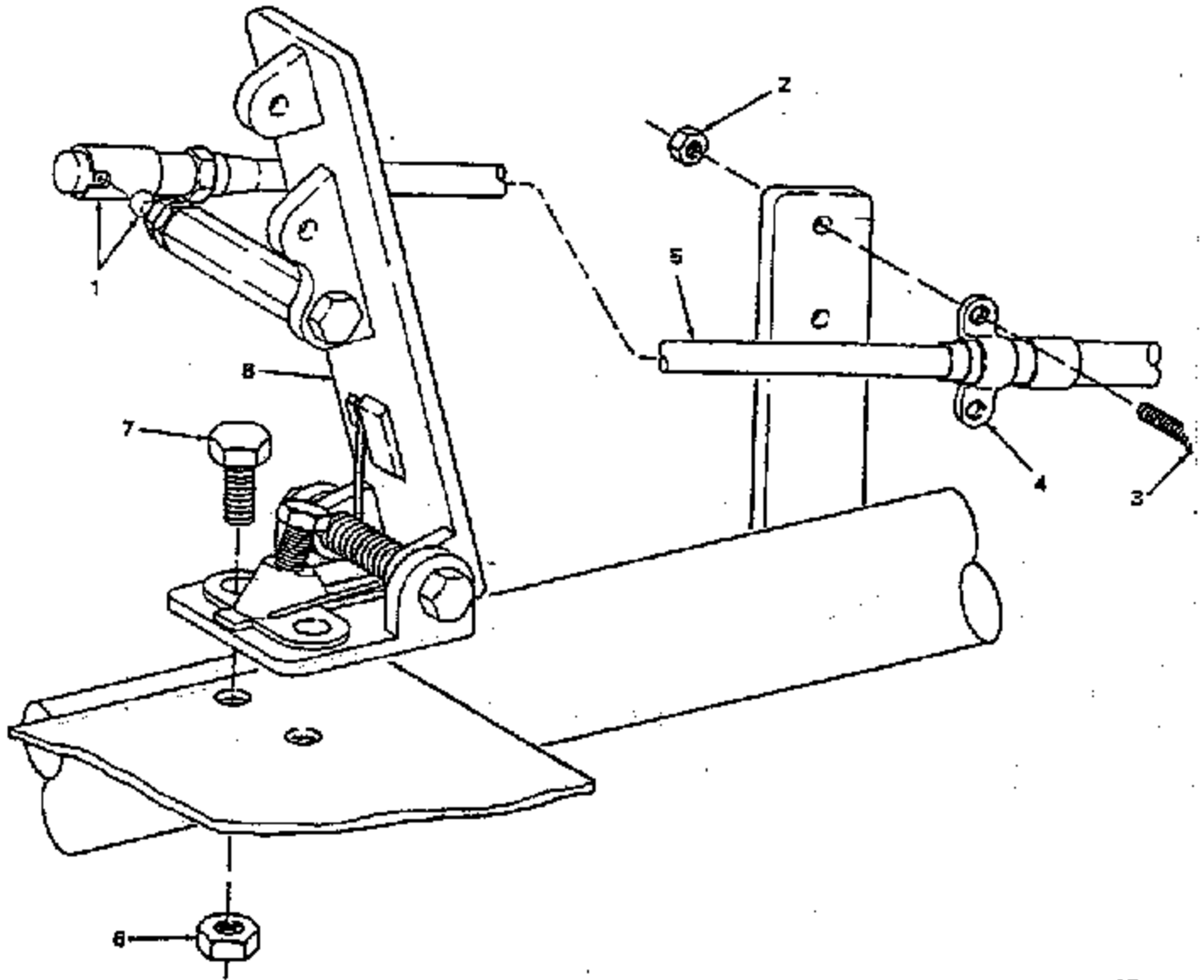

Figure 2-8. Fuel Tank

9FAVC



(1) ILLUSTRATION		(2)	(3)	(4)	(5)	(6) DESCRIPTION
(a) FIG NO.	(b) ITEM NO.	SMR CODE	NATIONAL STOCK NUMBER	PART NUMBER	FSCN	USABLE
						GROUP 0306 - FUEL TANK, LINES, AND
8	1	PA02Z		9-1133	20418	STRAP, FUEL TANK MOUNTING
8	2	PA02Z		8-1326	20418	SENDING UNIT, FUEL
8	3	PA02Z		9-1354	20418	CAP, FUEL TANK
8	4	PA02Z		9-1130	20418	TANK, FUEL
8	5	PA02Z		9-1132	20418	FILTER, FUEL
8	6	PA02Z		9-1131	20418	LINE, FUEL
8	7	PA02Z		9-1134	20418	CLAMP



SFAV04

Figure 2-9. Pedal and Throttle Cable

(1) ILLUSTRATION		(2)	(3)	(4)	(5)	(6) DESCRIPTION
(a) FIG NO.	(b) ITEM NO.	SHR CODE	NATIONAL STOCK NUMBER	PART NUMBER	FSCN	USABLE ON CODE
						GROUP 0512 - PEDAL AND THROTTLE CABLE
9	1	PA022		7-1201	20418	BALL JOINT, THROTTLE ADJUSTMENT
9	2	PA022		COML	COML	NUT, 10-32
9	3	PA022		COML	COML	SCREW, MACHINE: 10-32 X 3/4
9	4	PA022		7-1203	20418	CLAMP, THROTTLE CABLE
9	5	PA022		7-1200	20418	CABLE, THROTTLE
9	6	PA022		COML	COML	NUT, SELF-LOCKING: 1/4"
9	7	PA022		COML	COML	BOLT, MACHINE: 1/4-20 X 1
9	8	PA022		7-1199	20418	PEDAL ASSEMBLY, THROTTLE

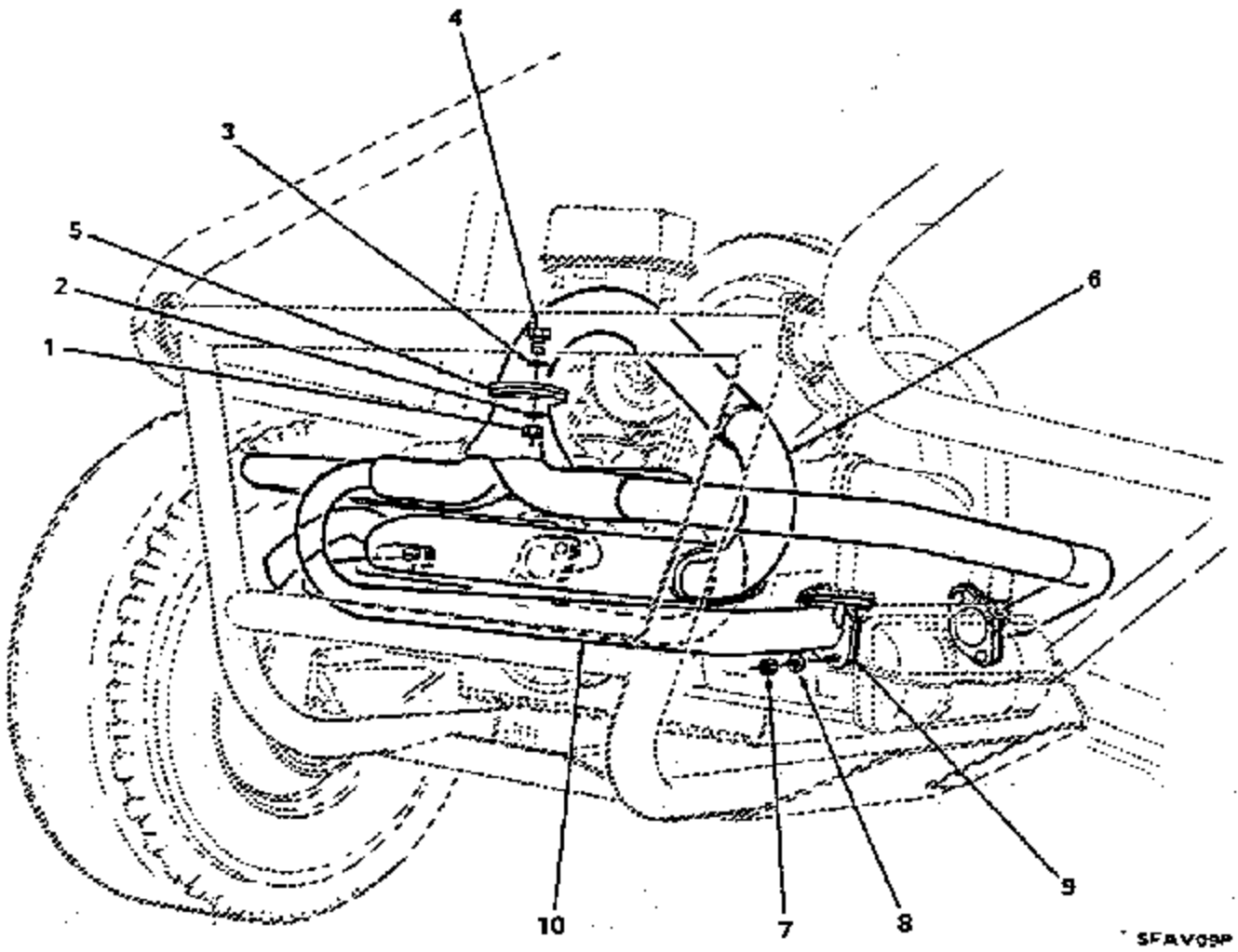

SFAV03P

Figure 2-10. Muffler and Exhaust Pipe

(1) ILLUSTRATION		(2)	(3)	(4)	(5)	(6) DESCRIPTION
(a) FIG NO.	(b) ITEM NO.	SMR CODE	NATIONAL STOCK NUMBER	PART NUMBER	FSCM	USABLE ON
10	1	PA02Z		COML	COML	GROUP 0401 - MUFFLER AND EXHAUST PUMP
10	2	PA02Z		COML	COML	NUT: 7/16
10	3	PA02Z		COML	COML	WASHER, LOCK: 7/16
10	4	PA02Z		COML	COML	WASHER, FLAT: 7/16
10	5	PA02Z		COML	COML	BOLT, MACHINE: 7/16 X 1-1/4
10	6	PA02Z		1-1367	2041B	GASKET, FLANGE
10	7	PA02Z		1-1366	2041B	MUFFLER
10	8	PA02Z		COML	COML	NUT: 8MM X 1.25 PITCH
10	9	PA02Z		COML	COML	WASHER, LOCK: 8MM
10	10	PA02Z		1-1368	2041B	GASKET
10				1-1356	2041B	EXHAUST SYSTEM

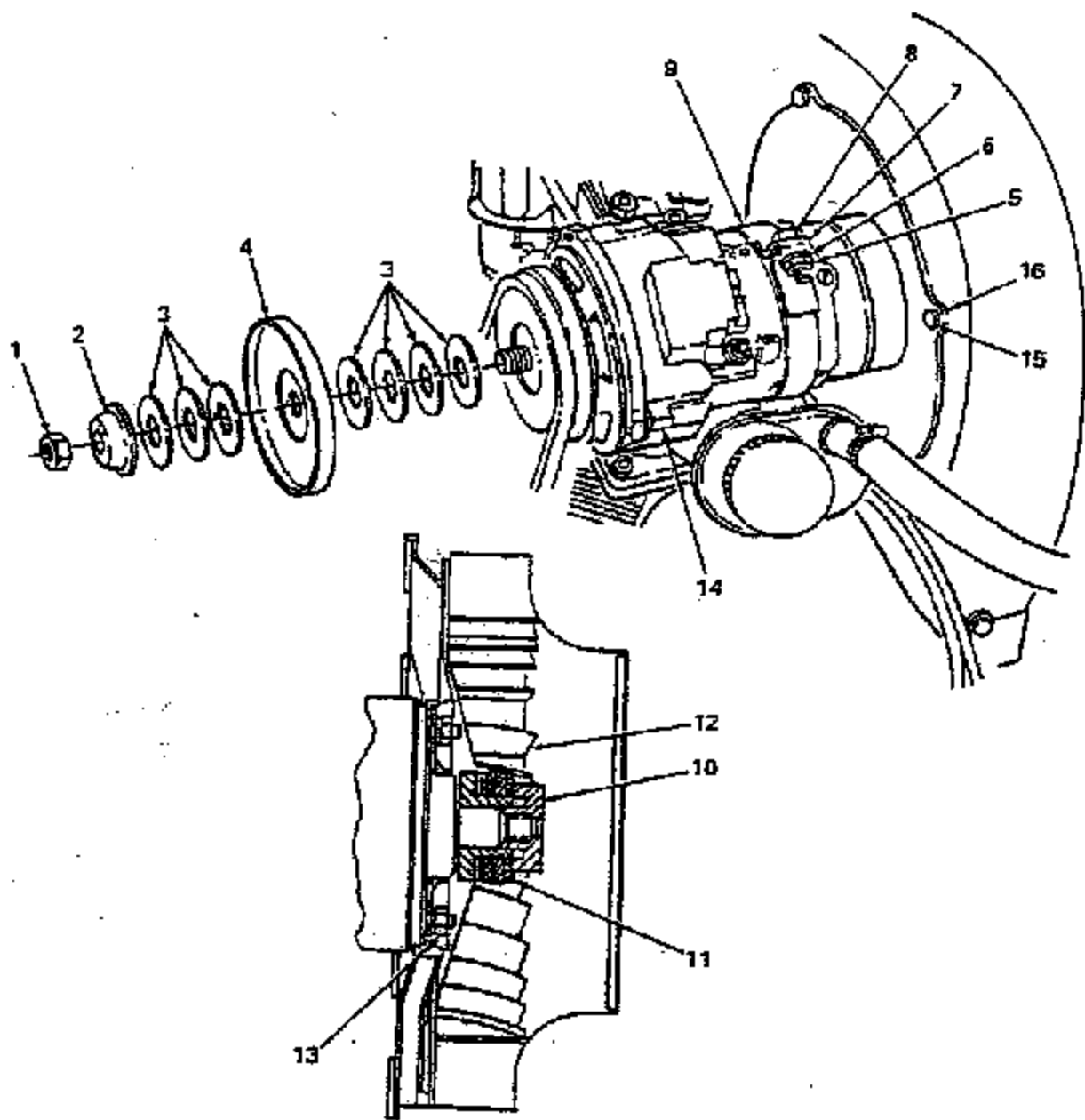

DETAIL A

Figure 2-11. Alternator/Regulator

(1) ILLUSTRATION		(2)	(3)	(4)	(5)	(6) DESCRIPTION
(a) FIG NO.	(b) ITEM NO.	SMR CODE	NATIONAL STOCK NUMBER	PART NUMBER	FSCN	USABLE ON COMB
						GROUP 0601 - ALTERNATOR/REGULATOR
11	1	PA0ZZ		8-1371	20418	NUT, SELF-LOCKING
11	2	PA0ZZ		8-1370	20418	SPACER
11	3	PA0ZZ		4-1330	20418	SHIM
11	4	PA0ZZ		8-1369	20418	PULLEY, HALF
11	5	PA0ZZ		COML	COML	NUT, 5/16-18
11	6	PA0ZZ		COML	COML	WASHER, LOCK: 5/16
11	7	PA0ZZ		COML	COML	WASHER, FLAT: 5/16
11	8	PA0ZZ		COML	COML	BOLT, MACHINE: 5/16-18 X 2
11	9	PA0ZZ		8-1372	20418	STRAP, ALTERNATOR MOUNTING
11	10	PA0ZZ		8-1374	20418	NUT, SELF-LOCKING
11	11	PA0ZZ		COML	COML	WASHER, FLAT: 12MM
11	12	PA0ZZ		8-1373	20418	FAN
11	13	PA0ZZ		COML	COML	BOLT, MACHINE: 6MM X 10MM
11	14	PA0LL		8-1304	20418	ALTERNATOR/REGULATOR ASSEMBLY
1	15	PA0ZZ		COML	COML	BOLT, MACHINE: 1/4-20 X 1/4
11	16	PA0ZZ		COML	COML	WASHER, LOCK: 1/4

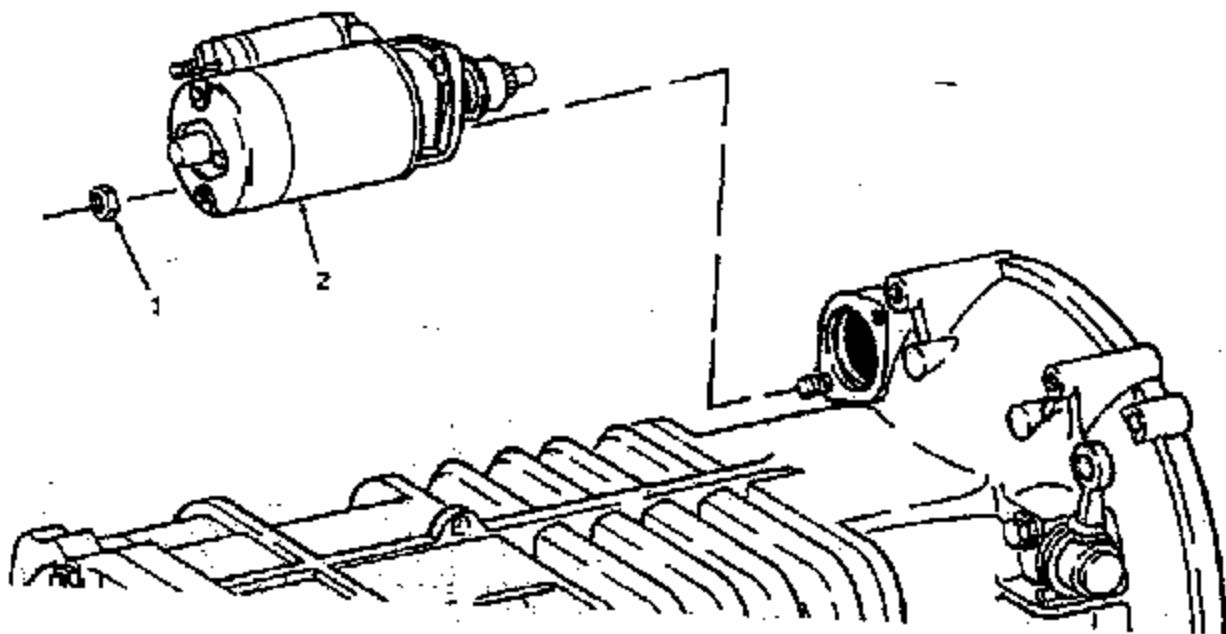

3PAV11P

Figure 2-12. Engine Starter



(1) ILLUSTRATION		(2)	(3)	(4)	(5)	(6)	(8)
(a) FIG NO.	(b) ITEM NO.	SMR CODE	NATIONAL STOCK NUMBER	PART NUMBER	FSCM	DESCRIPTION  <i>USABLE ON CASE</i>	QTY INC N MIT
12	1	PA02Z		COHL	COHL	GROUP 0601 - START MOTOR	
12	2	PA0LL		8-1231	20418	MUT, SELF-LOCKING: 10MM X 1.5 PITCH MOTOR, STARTING	

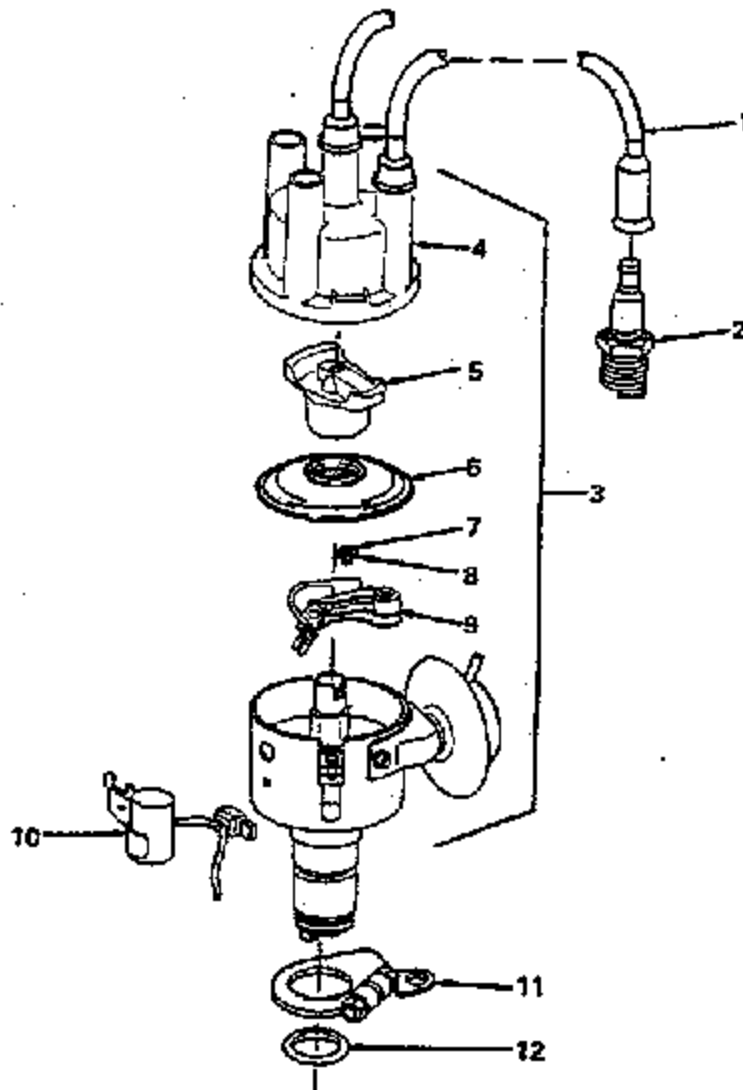
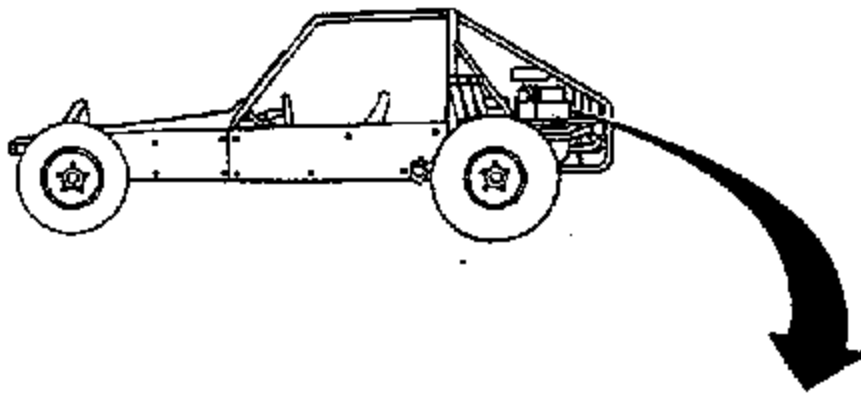

Figure 2-13. Ignition Components

SFAV12P

(1) ILLUSTRATION		(2)	(3)	(4)	(5)	(6) DESCRIPTION
(a) FIG NO.	(b) ITEM NO.	SMR CODE	NATIONAL STOCK NUMBER	PART NUMBER	PSCN	USABLE ON CDD
						GROUP 0605 - IGNITION COMPONENTS
13	1	PA022		1-1316	20418	WIRE SET, IGNITION
13	2	PA022		1-1315	20418	SPARK PLUG
13	3	PA000		1-1307	20418	DISTRIBUTOR ASSEMBLY--
13	4	PA022		1-1308	20418	CAP, DISTRIBUTOR
13	5	PA022		1-1309	20418	ROTOR
13	6	PA022		1-1388	20418	MOISTURE SEAL
13	7	PA022		1-1377	20418	SCREW, MACHINE
13	8	PA022		1-1378	20418	WASHER, FLAT
13	9	PA022		1-1310	20418	CONTACT SET
13	10	PA022		1-1311	20418	CONDENSOR
13	11	PA022		1-1376	20418	CLAMP, DISTRIBUTOR MOUNTING
13	12	PA022		1-1375	20418	PACKING, PREFORMED

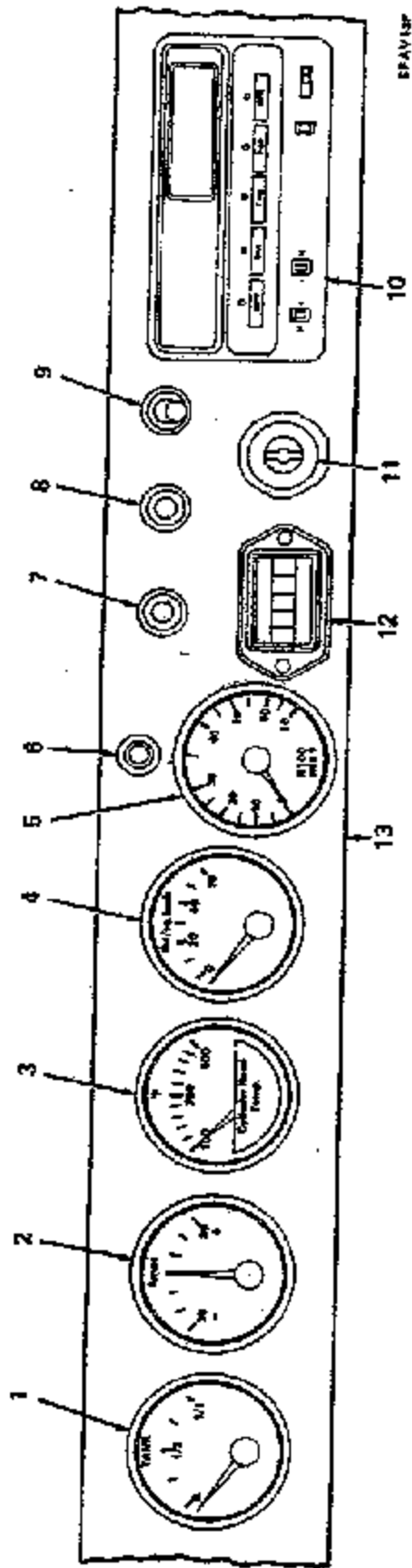

Figure 2-14. Instrument Control Panel

(1) ILLUSTRATION		(2)	(3)	(4)	(5)	(6) DESCRIPTION
(a) FIG NO.	(b) ITEM NO.	SMR CODE	NATIONAL STOCK NUMBER	PART NUMBER	FSCM	USABLE ON
						GROUP 0607 - INSTRUMENTS AND CONTROL PANEL
14	1	PA02Z		8-1227	20418	GAUGE, FUEL
14	2	PA02Z		8-1223	20418	AMMETER
14	3	PA02Z		8-1230	18418	GAUGE, TEMPERATURE, CYLINDER HEAD
14	4	PA02Z		8-1228	20418	GAUGE, OIL PRESSURE
14	5	PA02Z		8-1226	20418	TACHOMETER
14	6	PA02Z		8-1335	20418	INDICATOR, DIRECTIONAL
14	7	PA02Z		8-1236	20418	SWITCH, LIGHT, DIRECTIONAL
14	8	PA02Z		8-1233	20418	SWITCH, HEADLIGHT
14	9	PA02Z		8-1357	20418	SWITCH, TAILLIGHT
14	10	FB0LL		8-1225	20418	COMPUTER
14	11	PA02Z		8-1244	20418	SWITCH, IGNITION
14	12	PA02Z		8-1224	20418	HOUR METER
14	13	PA02Z		8-1237	20418	FLASHER, DIRECTIONAL LIGHT

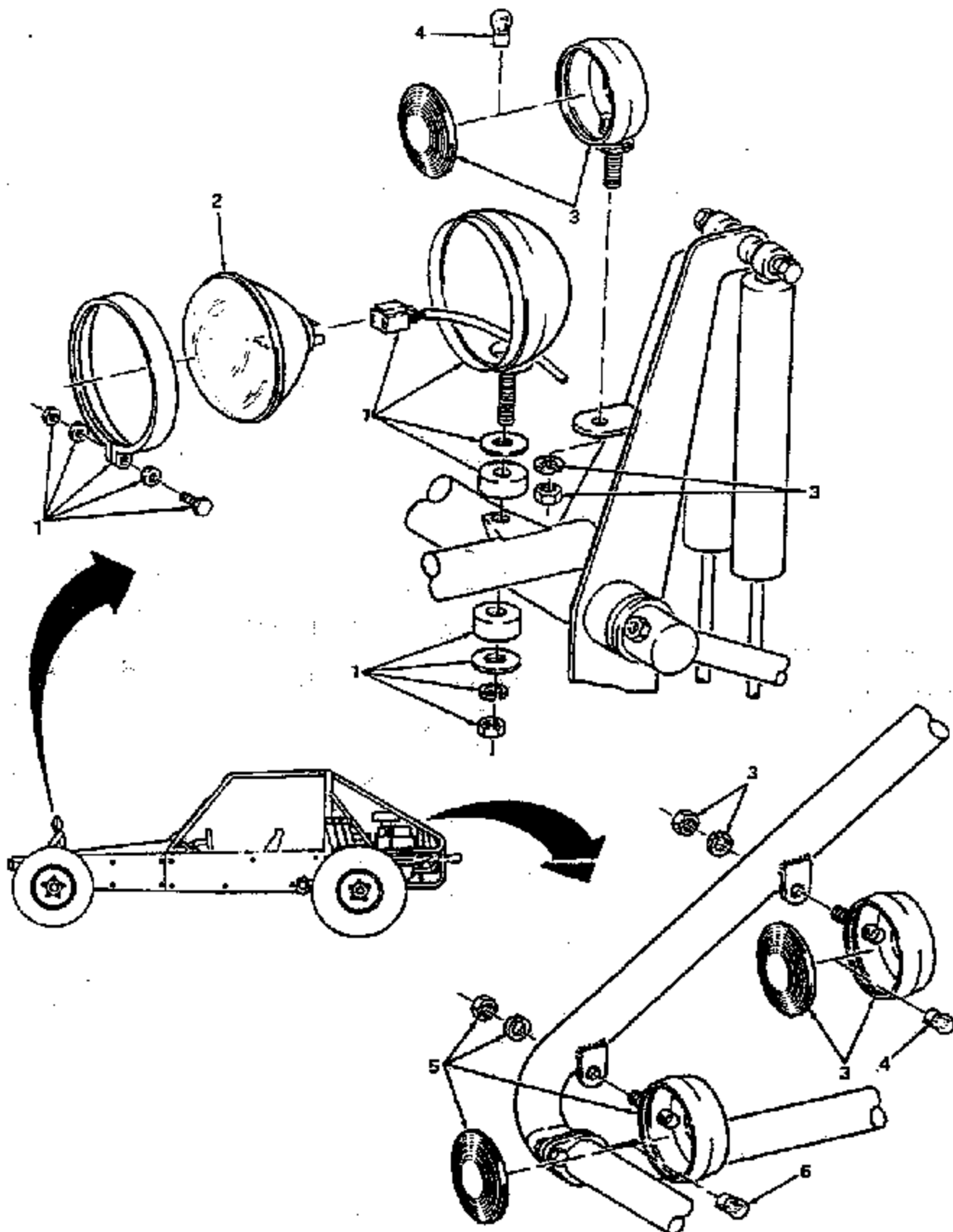

Figure 2-15. Lights

SFAV15P

(1) ILLUSTRATION		(2)	(3)	(4)	(5)	(5)
(a) FIG NO.	(b) ITEM NO.	SMR CODE	NATIONAL STOCK NUMBER	PART NUMBER	FSCM	DESCRIPTION
						GROUP 0609 - LIGHTS
15	1	PA000		8-1232	20418	HEADLIGHT ASSEMBLY
15	2	PA022		8-1322	20418	LAMP, INCANDESCENT
15	3	PA000		8-1235	20418	LIGHT ASSEMBLY, DIRECTIONAL
15	4	PA022		8-1379	20418	LAMP, INCANDESCENT
15	5	PA000		8-1234	20418	LIGHT ASSEMBLY, BRAKE
15	6	PA022		8-1323	20418	LAMP, INCANDESCENT

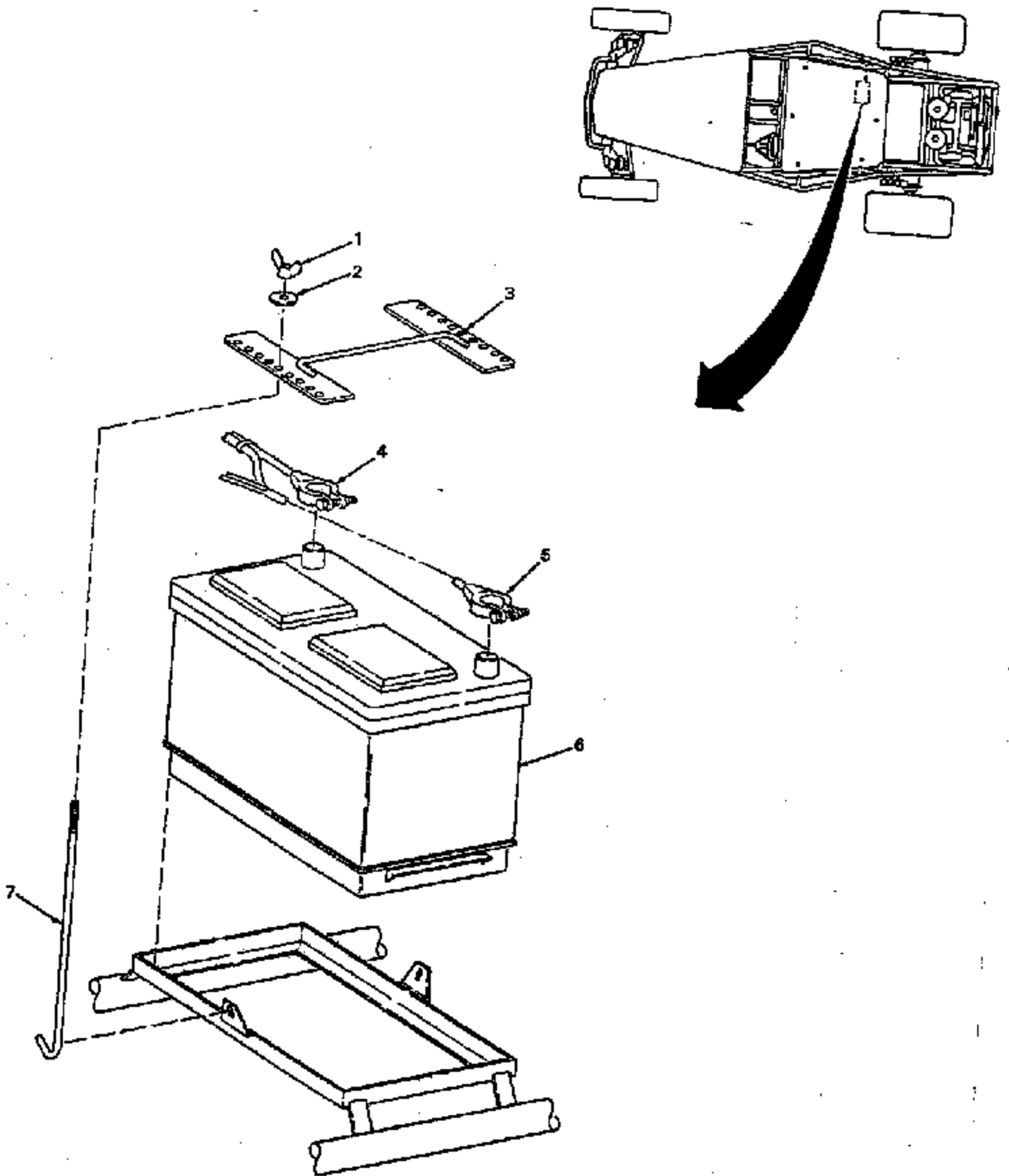
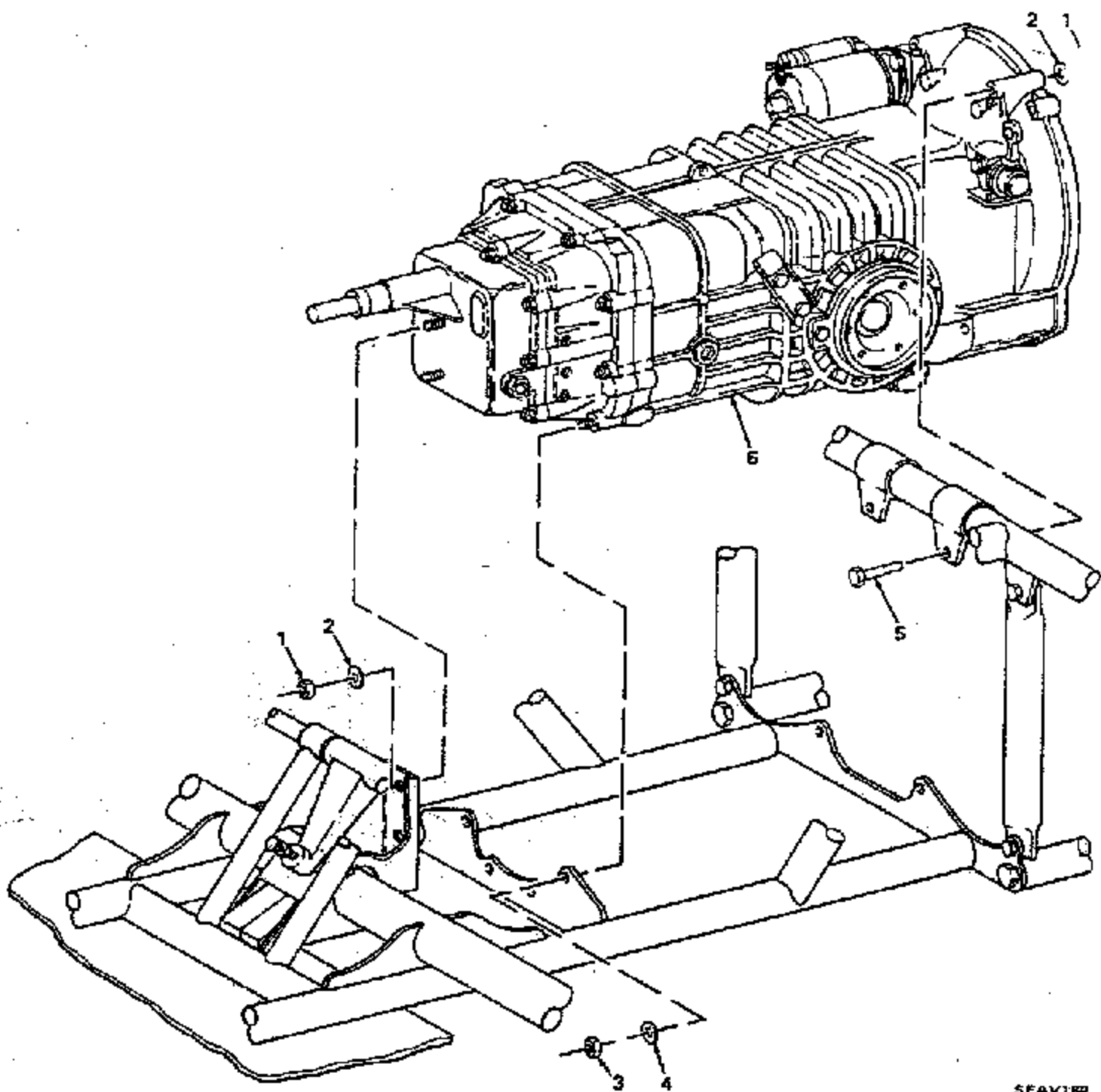

Figure 2-16. Battery

SPAV177



(1) ILLUSTRATION		(2)	(3)	(4)	(5)	(6) DESCRIPTION
(a) FIG NO.	(b) ITEM NO.	SNR CODE	NATIONAL STOCK NUMBER	PART NUMBER	FSCM	USABLE ON LOG.
16	1	PA02Z		COML	COML	GROUP 0612 - BATTERY
16	2	PA02Z		COML	COML	WING NUT: 1/4-20
16	3	PA02Z		8-1239	20418	WASHER, FLAT: 1/4
16	4	PA02Z		8-1241	20418	RETAINER, BATTERY
16	5	PA02Z		8-1242	20418	CABLE ASSEMBLY, POSITIVE
16	6	PA02Z		8-1238	20418	CABLE ASSEMBLY, NEGATIVE
16	7	PA02Z		8-1260	20418	BATTERY, STORAGE 100 AMP HR
						BOLT, BATTERY RETAINING



SFAV18P

Figure 2-17. Transmission Assembly

(1) ILLUSTRATION		(2)	(3)	(4)	(5)	(6)
(a) FIG NO.	(b) ITEM NO.	SMR CODE	NATIONAL STOCK NUMBER	PART NUMBER	FSCM	DESCRIPTION  <i>USABLE ON</i>
17	1	PAFZZ		COML	COML	GROUP 0700 - TRANSMISSION ASSEMBLY
17	2	PAFZZ		COML	COML	NUT: 10MM
17	3	PAFZZ		COML	COML	WASHER, FLAT: 10MM
17	4	PAFZZ		COML	COML	NUT: 8MM
17	5	PAFZZ		COML	COML	WASHER, FLAT: 8MM
17	6	PAFLL		3-1114	20418	BOLT, MACHINE: 10MM X 80MM-150 FITCH GRADE 5
17						TRANSMISSION ASSEMBLY

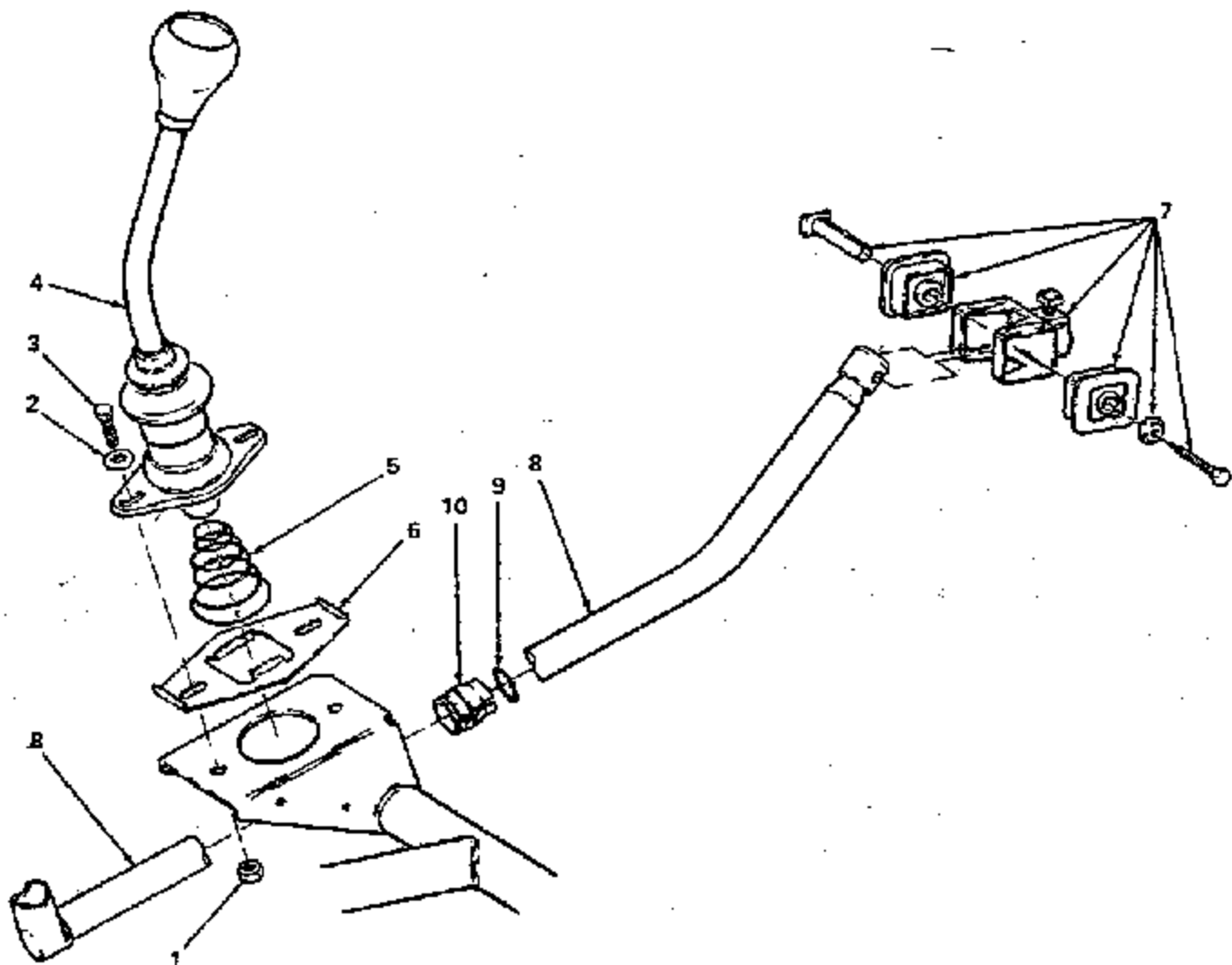

EFAV 340

Figure 2-18. Transmission Linkage

(1) ILLUSTRATION		(2)	(3)	(4)	(5)	(6)	(7)
(a) FIG NO.	(b) ITEM NO.	SMR CODE	NATIONAL STOCK NUMBER	PART NUMBER	FSCM	DESCRIPTION	QTY REQ BY UNIT
						GROUP 0705 - TRANSMISSION LINKAGE	
18	1	PA0ZZ		COML	COML	NUT, SELF-LOCKING: 5/16	
18	2	PA0ZZ		COML	COML	WASHER, FLAT: 5/16	
18	3	PA0ZZ		COML	COML	BOLT, MACHINE: 5/16 X 3/4	
18	4	PA0ZZ		7-1204	20418	SHIFT ASSEMBLY, GEAR	
18	5	PA0ZZ		7-1209	20418	SPRING	
18	6	PA0ZZ		7-1210	20418	PLATE, REVERSE LOCKOUT	
18	7	PA0ZZ		7-1207	20418	COUPLER: LINKAGE ROD TO TRANSMISSION	
18	8	PA0ZZ		7-1211	20418	ROD, LINKAGE	
18	9	PA0ZZ		7-1214	20418	RING, RETAINING	
18	10	PA0ZZ		7-1213	20418	BUSHING	

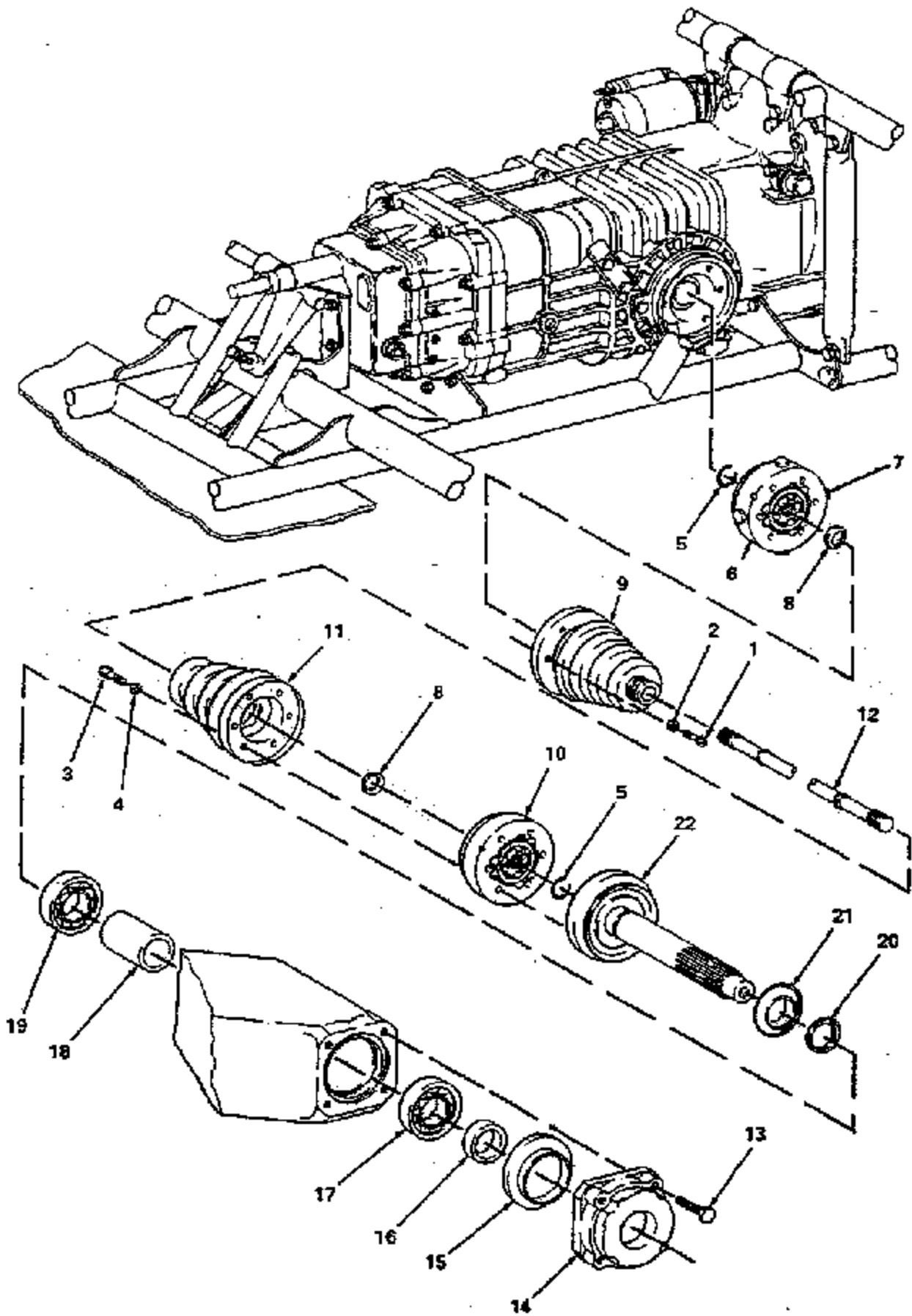
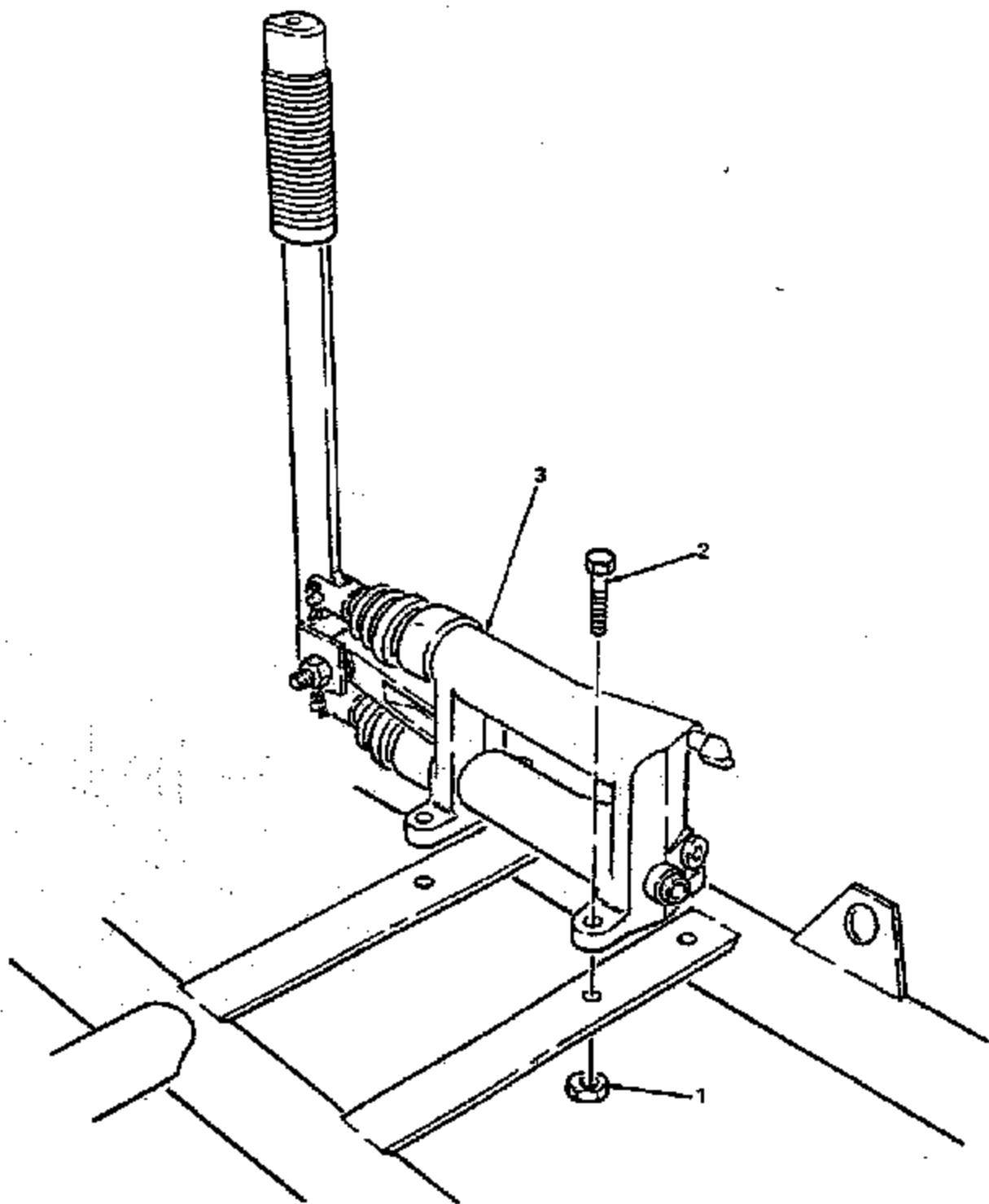

Figure 2-19. Final Drive Assembly

(1) ILLUSTRATION		(2)	(3)	(4)	(5)	(6)	(8)
(a) FIG NO.	(b) ITEM NO.	SMR CODE	NATIONAL STOCK NUMBER	PART NUMBER	FSCM	DESCRIPTION  USABLE ON CUTS	QTY INC IN KIT
						GROUP 0807 - FINAL DRIVE	
19	1	PA02Z		5-1193	20418	BOLT, MACHINE	
19	2	PA02Z		5-1195	20418	WASHER, LOCK	
19	3	PA02Z		5-1340	20418	BOLT, MACHINE	
19	4	PA02Z		5-1349	20418	BOLT, MACHINE	
19	5	PA02Z		5-1194	20418	RING, RETAINING	
19	6	PA02Z		5-1191	20418	CONSTANT VELOCITY JOINT, INNER	
19	7	PA02Z		8-1381	20418	MAGNET	
19	8	PA02Z		5-1389	20418	WASHER, CONCAVE	
19	9	PA02Z		5-1192	20418	BOOT ASSEMBLY, INNER	
19	10	PA02Z		5-1353	20418	CONSTANT VELOCITY JOINT, OUTER	
19	11	PA02Z		5-1382	20418	BOOT ASSEMBLY, OUTER	
19	12	PA02Z		5-1167	20418	DRIVE AXLE	
19	13	PA02Z		COML	COML	BOLT, MACHINE: 3/8-16 X 2, GRADE 8	
19	14	PA02Z		5-1174	20418	COVER, BEARING	
19	15	PA02Z		5-1173	20418	SPACER, BEARING, OUTER	
19	16	PA02Z		5-1175	20418	SPACER, BEARING, INNER	
19	17	PA02Z		5-1172	20418	WHEEL BEARING ASSEMBLY: OUTER	
19	18	PA02Z		5-1169	20418	SPACER	
19	19	PA02Z		5-1171	20418	WHEEL BEARING ASSEMBLY: INNER	
19	20	PA02Z		5-1176	20418	RING, SNAP	
19	21	PA02Z		5-1170	20418	SEAL	
19	22	PA02Z		5-1166	20418	STEER AXLE	



SFAY20P

Figure 2-20. Cutting Brake



(1) ILLUSTRATION		(2)	(3)	(4)	(5)	(6)	(7)	(8)
(a) FIG NO.	(b) ITEM NO.	SMR CODE	NATIONAL STOCK NUMBER	PART NUMBER	FSCN	DESCRIPTION  <i>USABLE ON CODE</i>	U/M	QTY INC IN UNIT
20	1	PA02Z		COM1	COM1	GROUP 1201 - CUTTING BRAKE		
20	2	PA02Z		COM1	COM1	NUT, SELF-LOCKING: 1/4-20	EA	4
20	3	PA02Z		6-1293	20418	BOLT, MACHINE: 1/4-20 X 1	EA	4
						CUTTING BRAKE	EA	1

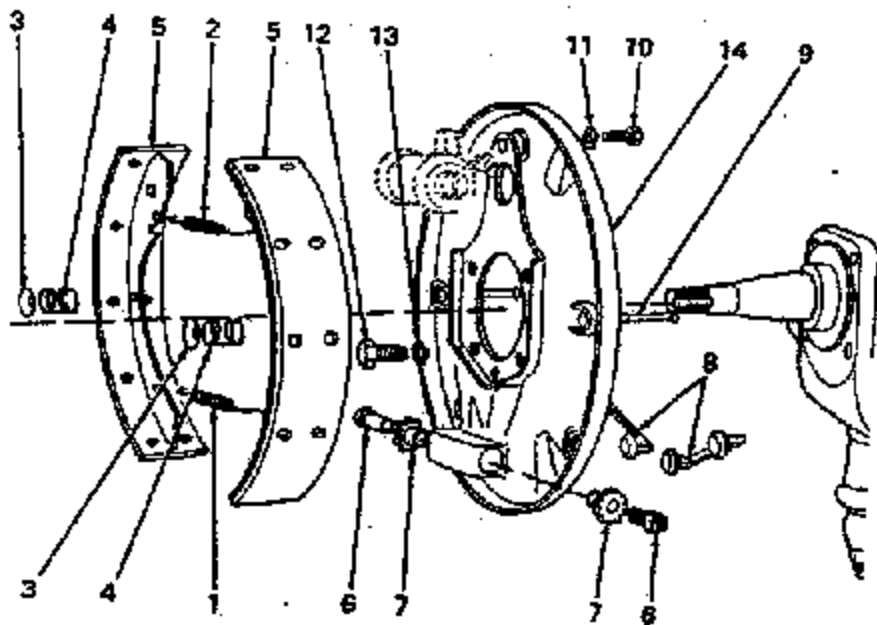
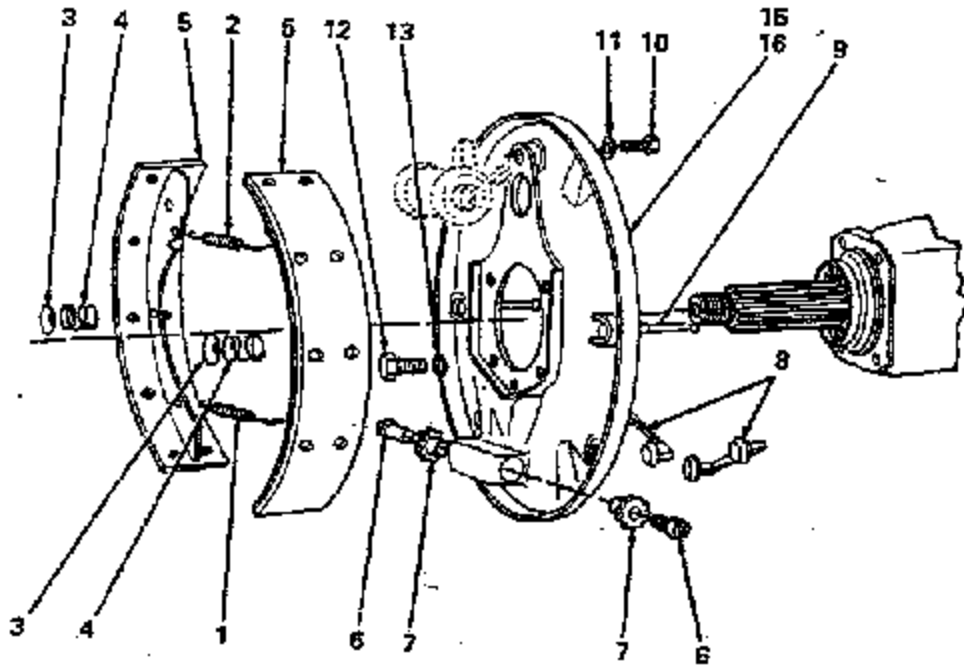

Figure 2-21. Service Brakes

SFAV21P

(1) ILLUSTRATION		(2)	(3)	(4)	(5)	(6) DESCRIPTION
(a) FIG NO.	(b) ITEM NO.	SMR CODE	RATIONAL STOCK NUMBER	PART NUMBER	FSCM	USABLE ON
						GROUP 1202 - BRAKE SHOES
21	1	PA022		6-1268	20418	SPRING, RETURN
21	2	PA022		6-1267	20418	SPRING, RETURN
21	3	PA022		6-1263	20418	SEAT, SPRING
21	4	PA022		6-1262	20418	SPRING
21	5	PA022		6-1270	20418	SHOE, BRAKE
21	6	PA022		6-1259	20418	SCREW, ADJUSTING
21	7	PA022		6-1260	20418	NUT, ADJUSTING
21	8	PA022		6-1266	20418	DUST PLUGS
21	9	PA022		6-1261	20418	PIB
21	10	PA022		COML	COML	BOLT, MACHINE: 8MM X 15MM X 1.25
21	11	PA022		COML	COML	WASHER, LOCK: 8MM
21	12	PA022		COML	COML	BOLT, MACHINE: 3/8 X 1
21	13	PA022		COML	COML	WASHER, LOCK: 3/8
21	14	PA022		6-1265	20418	BACKING PLATE - FRONT
21	15	PA022		6-1279	20418	BACKING PLATE - RIGHT REAR
1	16	PA022		6-1278	20418	BACKING PLATE - LEFT REAR

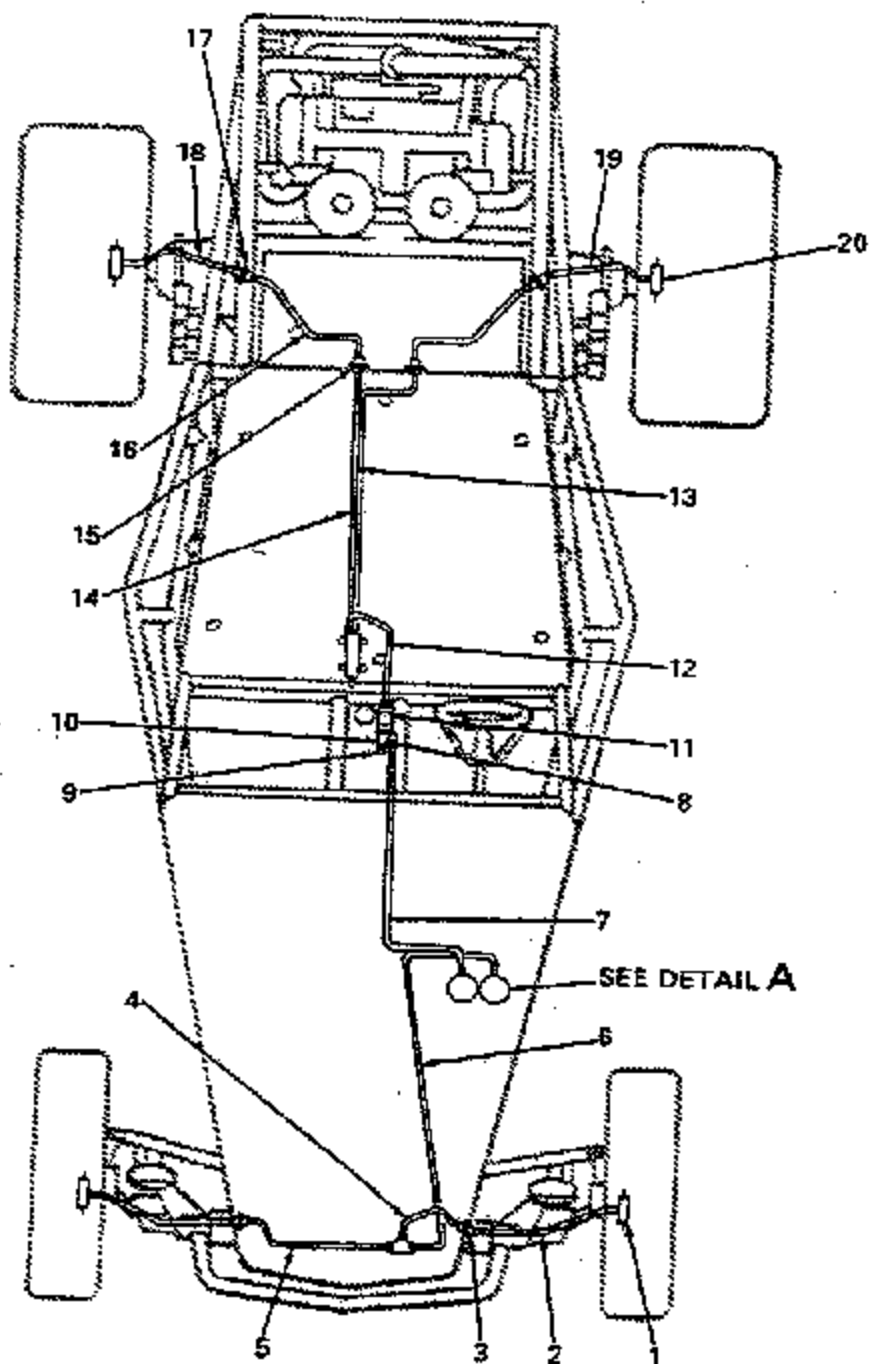
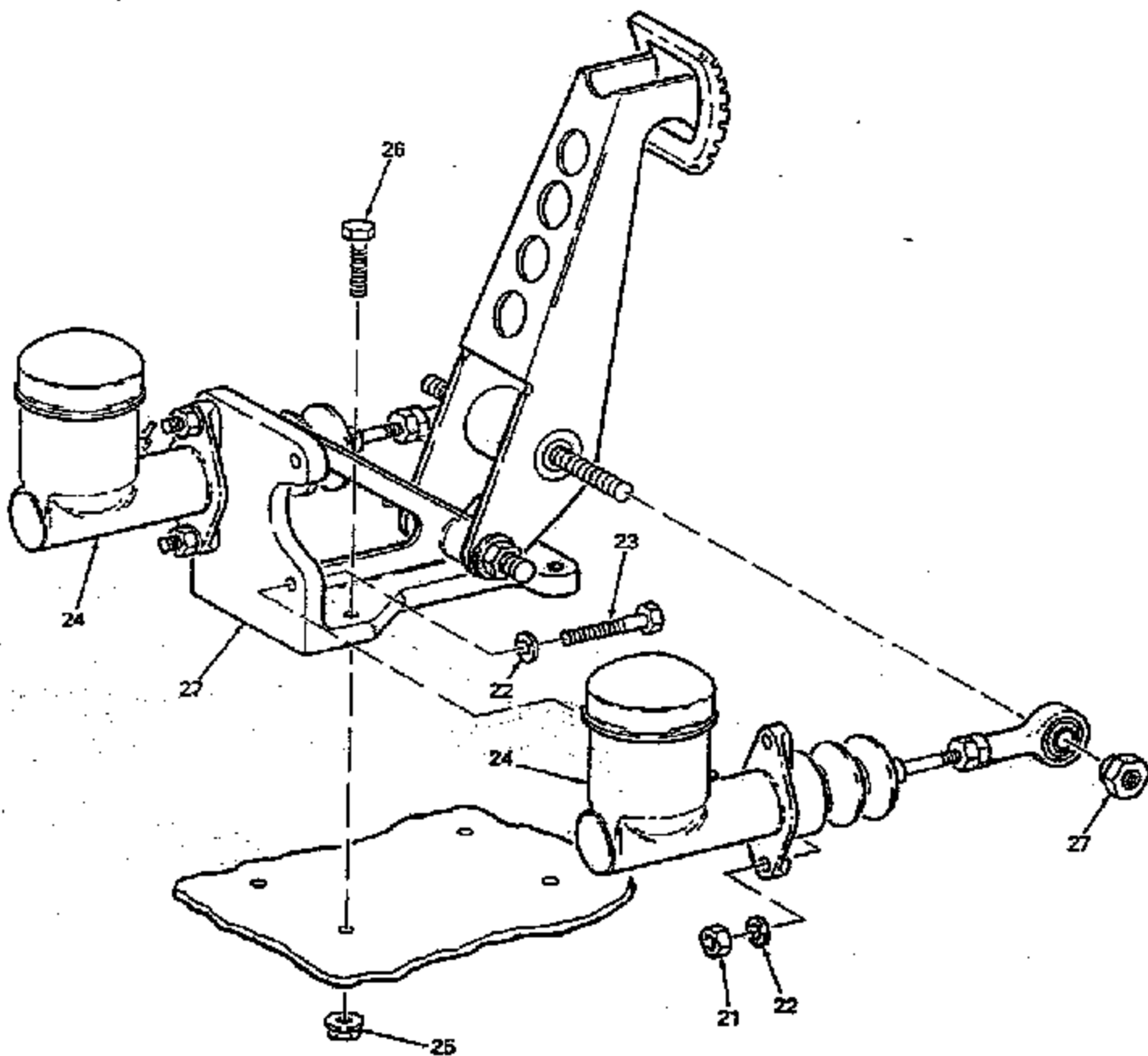

Figure 2-21. Brake Hydraulic System (Sheet 1 of 2)

(1) ILLUSTRATION		(2)	(3)	(4)	(5)	(6) DESCRIPTION
(a) FIG NO.	(b) ITEM NO.	SMR CODE	NATIONAL STOCK NUMBER	PART NUMBER	FSCN	USABLE ON CGIS
						GROUP 1204 - BRAKE HYDRAULIC SYSTEM
12	1	PA022		6-1264	20418	WHEEL CYLINDER, FRONT
22	2	PA022		6-1274	20418	BRAKE HOSE, FRONT
22	3	PA022		6-1275	20418	CLIP
22	4	PA022		6-1246	20418	BRAKE LINE, STEEL
22	5	PA022		6-1247	20418	BRAKE LINE, STEEL
22	6	PA022		6-1248	20418	BRAKE LINE, STEEL
22	7	PA022		6-1249	20418	BRAKE LINE, STEEL
22	8	PA022		COML	COML	ELBOW, TUBE: 1/8 to 3/16
22	9	PA022		6-1255	20418	SWITCH, BRAKE LIGHT
22	10	PA022		COML	COML	TEE, TUBE: 1/8
22	11	PA022		6-1256	20418	PARK LOCK
22	12	PA022		6-1250	20418	BRAKE LINE, STEEL
22	13	PA022		6-1252	20418	BRAKE LINE, STEEL
22	14	PA022		6-1251	20418	BRAKE LINE, STEEL
2	15	PA022		6-1380	20418	UNION
22	16	PA022		6-1294	20418	BRAKE HOSE, REAR
22	17	PA022		6-1329	20418	CLIP
22	18	PA022		6-1253	20418	BRAKE LINE, STEEL
12	19	PA022		6-1254	20418	BRAKE LINE, STEEL
12	20	PA022		6-1280	20418	WHEEL CYLINDER, REAR



DETAIL A

SFAV22P(2)

Figure 2-22. Brake Hydraulic System (Sheet 2 of 2)

(1) ILLUSTRATION		(2)	(3)	(4)	(5)	(6)
(a) FIG NO.	(b) ITEM NO.	SHR CODE	NATIONAL STOCK NUMBER	PART NUMBER	FSCM	DESCRIPTION
						USABLE ON 1150
						GROUP 1204 - BRAKE HYDRAULIC SYSTEM (CONT.)
22	21	PA0ZZ		COML	COML	NUT: 5/16 - 18
22	22	PA0ZZ		COML	COML	WASHER, LOCK: 5/16
22	23	PA0ZZ		COML	COML	BOLT, MACHINE: 5/16 - 18 X 1-1/4
22	24	PA0ZZ		6-1324	2041B	MASTER CYLINDER, BRAKE
22	25	PA0ZZ		COML	COML	NUT, SELF-LOCKING: 1/4 - 20
22	26	PA0ZZ		COML	COML	BOLT, MACHINE: 1/4 - 20 X 1
22	27	PA0ZZ		6-1245	2041B	PEDAL ASSEMBLY, BRAKE

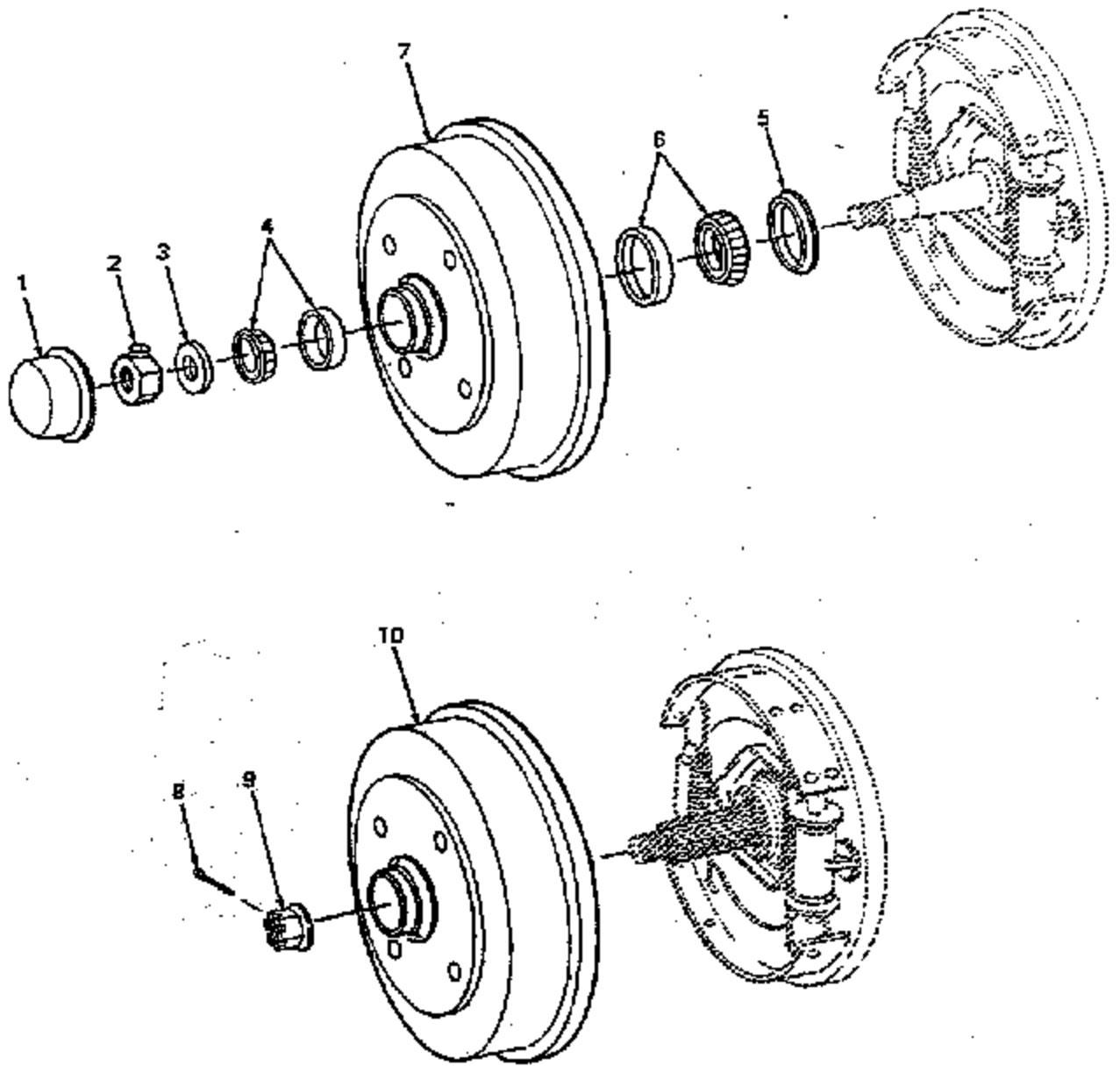

SFAV23P

Figure 2-23. Wheel Components



(1) ILLUSTRATION		(2)	(3)	(4)	(5)	(6)	(7)	(8)
(a) FIG NO.	(b) ITEM NO.	SPR CODE	NATIONAL STOCK NUMBER	PART NUMBER	FSCN	DESCRIPTION  USABLE ON CODE	U/M	QTY INC IN UNIT
						GROUP 1313 - WHEEL COMPONENTS		
23	1	PAOZZ		4-1334	20418	CAP, DUST	EA	2
23	2	PAOZZ		4-1338	20418	NUT	EA	2
23	3	PAOZZ		COHL	COHL	WASHER, FLAT	EA	2
23	4	PAOZZ		4-1326	20418	WHEEL BEARING ASSEMBLY, OUTER	EA	2
23	5	PAOZZ		5-1170	20418	SEAL	EA	4
23	6	PAOZZ		4-1325	20418	WHEEL BEARING ASSEMBLY, INNER	EA	2
23	7	PAOZZ		6-1258	20418	DRUM, FRONT	EA	2
23	8	PAOZZ		COHL	COHL	PIN, COTTER: 3/16 X 3	EA	2
23	9	PAOZZ		5-1333	20418	NUT	EA	2
23	10	PAOZZ		6-1277	20418	DRUM, REAR	EA	2

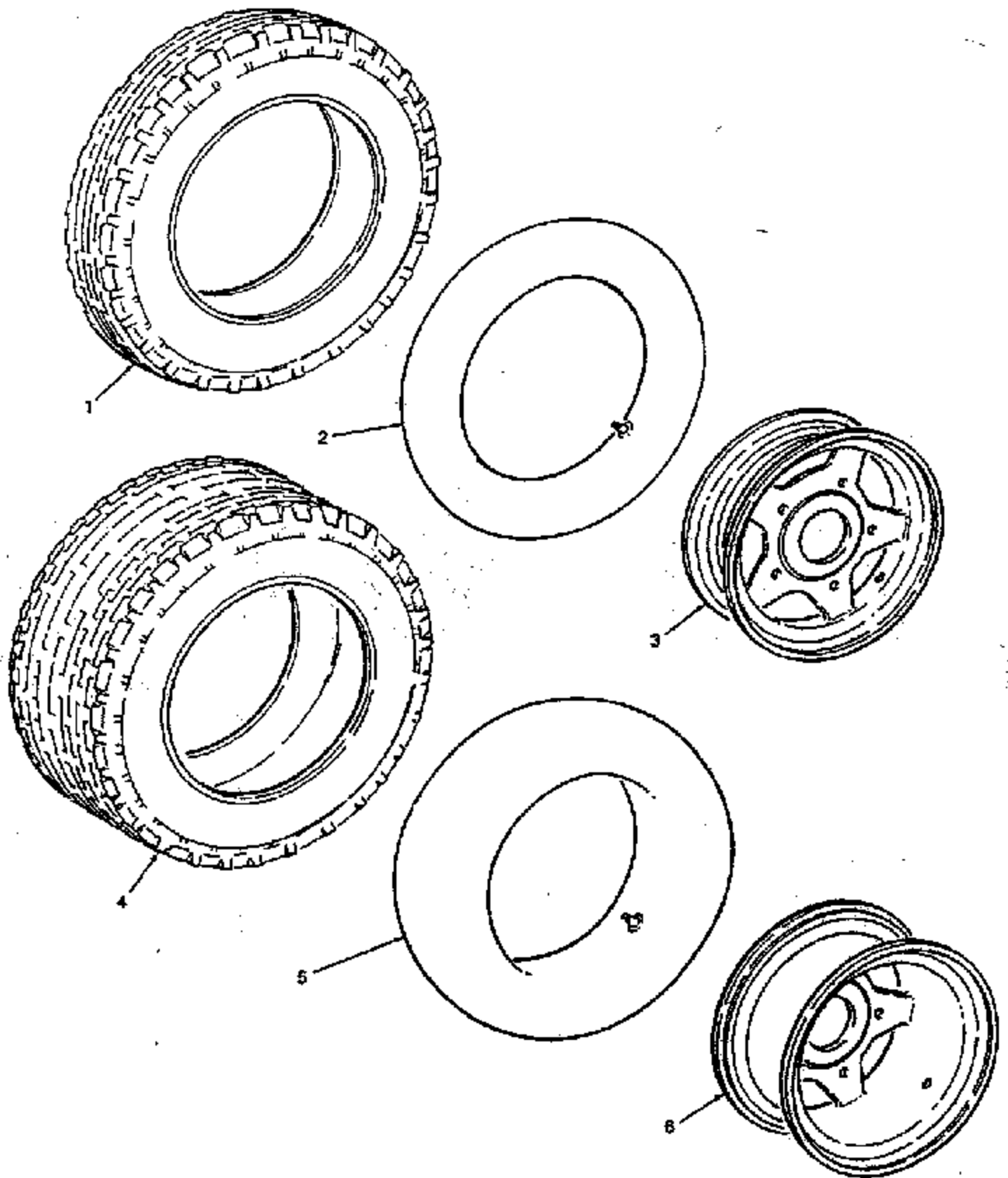

Figure 2-24. Tires, Tubes and Wheels

SPAYOR

(1) ILLUSTRATION		(2)	(3)	(4)	(5)	(6)
(a) FIG NO.	(b) ITEM NO.	SMR CODE	NATIONAL STOCK NUMBER	PART NUMBER	FSCN	DESCRIPTION
						GROUP 1313 - TIRES, TUBES AND WHEELS
24	1	PAQZZ		7-1215	20418	TIRE, FRONT
24	2	PAQZZ		7-1222	20418	TUBE, FRONT
24	3	PAQZZ		7-1217	20418	WHEEL, FRONT
24	4	PAQZZ		7-1216	20418	TIRE, REAR
24	5	PAQZZ		7-1221	20418	TUBE, REAR
24	6	PAQZZ		7-1218	20418	WHEEL, REAR

USABLE ON 1009

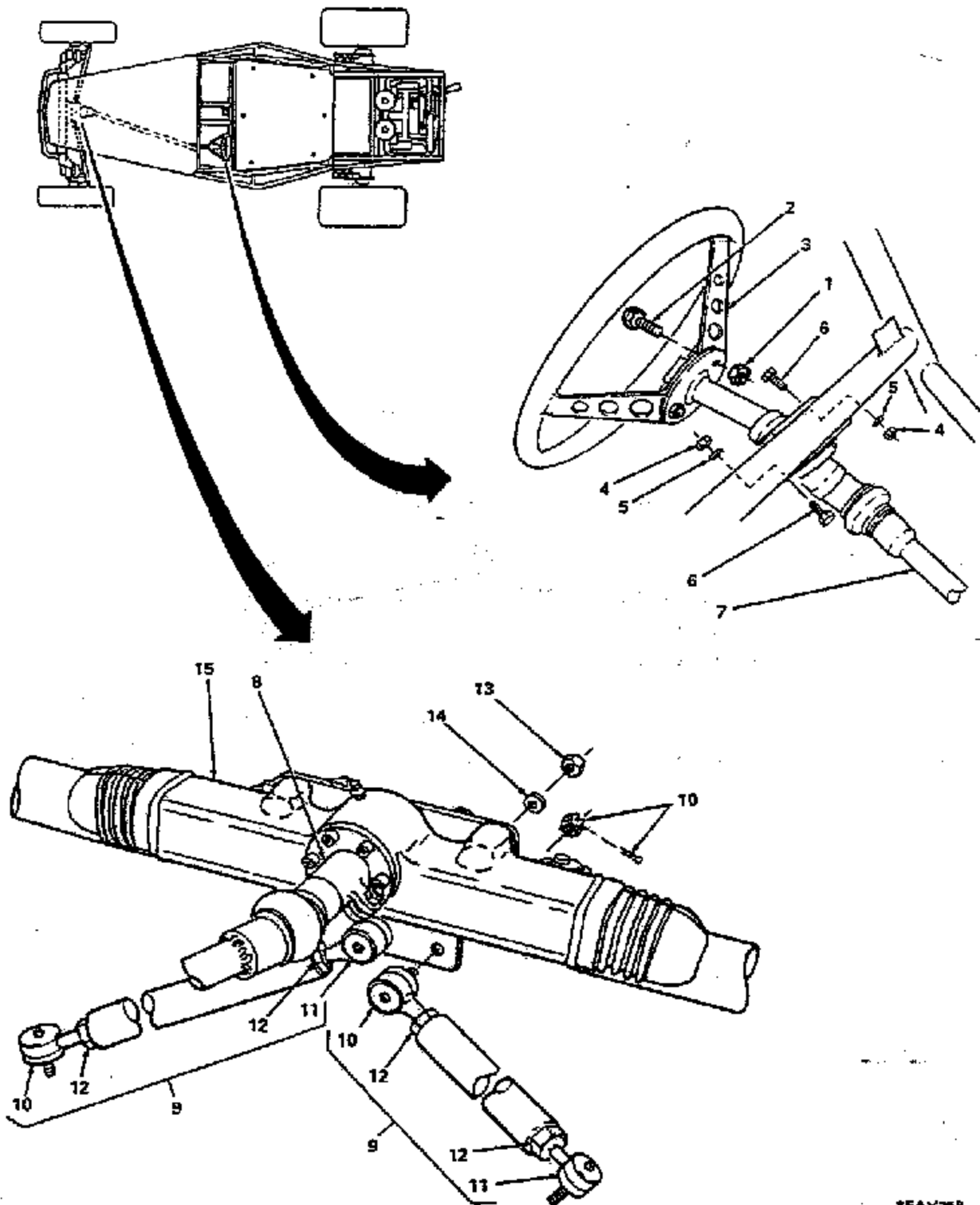
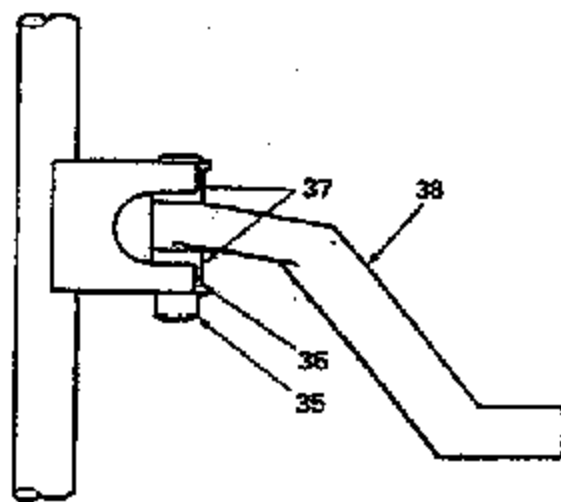
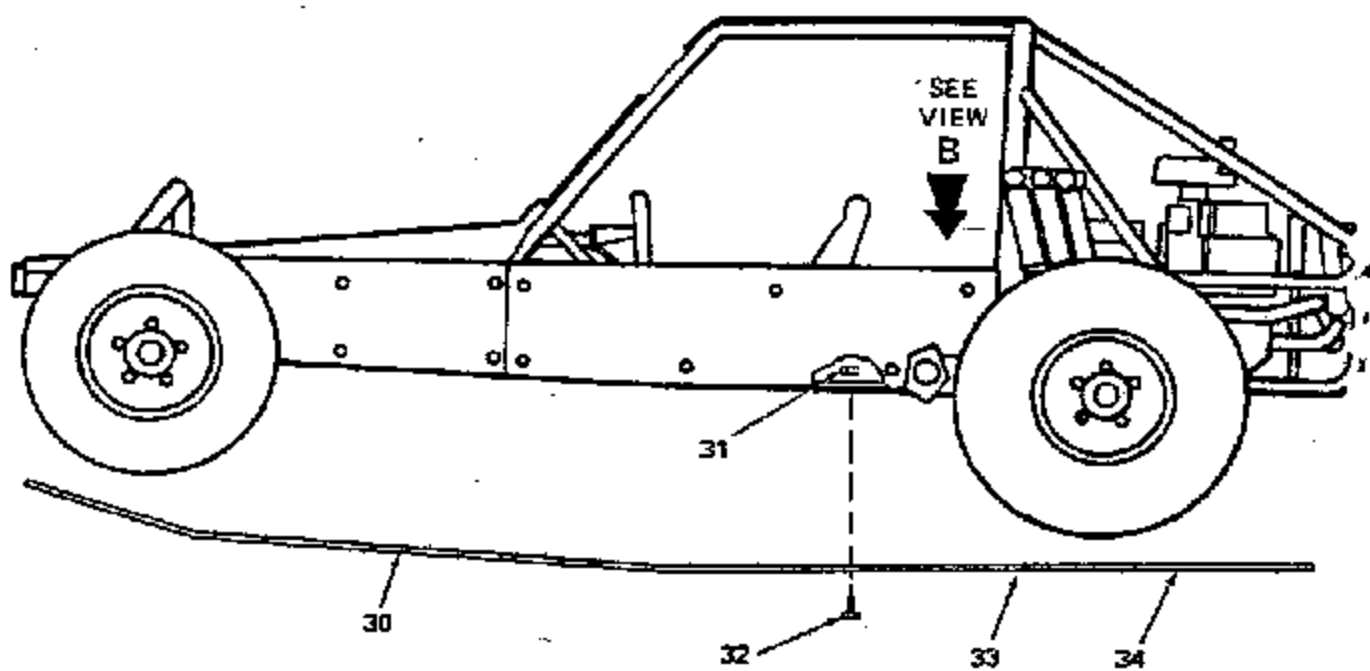

Figure 2-25. Mechanical Steering Assembly

8FAY25P

(1) ILLUSTRATION		(2)	(3)	(4)	(5)	(6)	(8)
(a) FIG NO.	(b) ITEM NO.	SMR CODE	NATIONAL STOCK NUMBER	PART NUMBER	FSCN	DESCRIPTION  <i>USABLE ON CODE</i>	QTY INC IN UNIT
						GROUP 1401 - MECHANICAL STEERING ASSEMBLY	
25	1	PA0ZZ		COML	COML	NUT, SELF-LOCKING: 1/4 - 20	3
25	2	PA0ZZ		COML	COML	BOLT, MACHINE: 1/4 - 20 X 3/4	3
25	3	PA0ZZ		4-1162	20418	WHEEL, STEERING	1
25	4	PA0ZZ		COML	COML	NUT: 1/4 - 20	2
25	5	PA0ZZ		COML	COML	WASHER, LOCK: 1/4	2
25	6	PA0ZZ		COML	COML	BOLT, MACHINE: 1/4 - 20 X 1	1
25	7	PA0ZZ		4-1159	20418	SHAFT, STEERING	1
25	8	PA0ZZ		4-1345	20418	COUPLER, STEERING BOX	1
25	9	PA0ZZ		4-1146	20418	TIE ROD ASSEMBLY	1
25	10	PA0ZZ		4-1298	20418	TIE ROD END	1
25	11	PA0ZZ		4-1299	20418	TIE ROD END	1
25	12	PA0ZZ		4-1148	20418	JAM NUT	1
25	13	PA0ZZ		COML	COML	NUT: 3/8 SAE	1
25	14	PA0ZZ		COML	COML	WASHER, LOCK: 3/8	1
25	15	PA0LL		4-1158	20418	STEERING BOX	1

(1) ILLUSTRATION		(2)	(3)	(4)	(5)	(6) DESCRIPTION	(7)
(a) FIG NO.	(b) ITEM NO.	SMR CODE	NATIONAL STOCK NUMBER	PART NUMBER	FSCM	USABLE ON COMB	UNIT
						GROUP 1501 - FRAME COMPONENTS	
26	1	PAOZZ		COML	COML	NUT, SELF-LOCKING: 3/8 - 16	
26	2	PAOZZ		COML	COML	WASHER, FLAT: 3/8	
26	3	PAOZZ		4-1156	20418	CLAMP	
26	4	PAOZZ		4-1137	20418	SHIM	
26	5	PAOZZ		4-1153	20418	BOLT, MACHINE	
26	6	PAOZZ		COML	COML	NUT, SELF-LOCKING: 5/16 - 18	
26	7	PAOZZ		COML	COML	BOLT, MACHINE: 5/16 - 18 X 1	
26	8	PAOZZ		4-1145	20418	PAD, BUMPER	
26	9	PAOLL		4-1144	20418	SEAM, FRONT	
26	10	PAOZZ		9-1123	20418	BUMPER, FRONT	
26	11	PAFZZ		5-1179	20418	PLATE, SPRING	
26	12	PAFZZ		5-1186	20418	STOP	
26	13	PAFZZ		5-1177	20418	TORSION BAR	
26	14	PAFZZ		5-1182	20418	END CAP, TORSION BAR	
26	15	PAFZZ		5-1181	20418	BUSHING	
26	16	PAFZZ		5-1183	20418	BOLT, MACHINE	
26	17	PAFZZ		5-1184	20418	WASHER, FLAT	
26	18	PAFZZ		5-1185	20418	NUT, SELF-LOCKING	
26	19	PAFZZ		5-1178	20418	BOLT, TORSION BAR ADJUSTMENT	
26	20	PAFZZ		COML	COML	BOLT, MACHINE: 3/8 - 16 x 1-3/4, GRADE 8	
26	21	PAFZZ		5-1189	20418	SWAY BAR ASSEMBLY	
26	22	PAFZZ		COML	COML	WASHER, FLAT: 5/16	
26	23	PAFZZ		COML	COML	BOLT, MACHINE: 5/16 X 3/4	
26	24	PAFZZ		5-1362	20418	ROD END, SPHERICAL	
26	25	PAFZZ		5-1384	20418	NUT, LOCKING	
26	26	PAFZZ		5-1383	20418	SLEEVE	
26	27	PAFZZ		5-1385	20418	NUT, LOCKING	
26	28	PAFZZ		COML	COML	BOLT, MACHINE: 1/2 X 2	
26	29	PAFZZ		5-1341	20418	ROD END, SPHERICAL	



VIEW  
B

Figure 2-26. Frame Components (Sheet 2 of 2)

SPAVZPL

(1) ILLUSTRATION		(2)	(3)	(4)	(5)	(6) DESCRIPTION
(a) FIG NO.	(b) ITEM NO.	SMR CODE	NATIONAL STOCK NUMBER	PART NUMBER	FSCN	USABLE ON COMB
						GROUP 1501 - FRAME COMPONENTS (CONTL.)
26	30	PA022		9-1122	20418	FLOOR PLATE
26	31	PA022		COML	COML	NUT, SELF-LOCKING: 3/8 - 16
26	32	PA022		COML	COML	BOLT, MACHINE: 3/8 - 16 X 1
26	33	PA022		9-1129	20418	PLATE, SKID, TRANSMISSION
26	34	PA022		9-1128	20418	PLATE, SKID, ENGINE
26	35	PA022		5-1187	20418	BOLT, MACHINE
26	36	PA022		5-1188	20418	WASHER, FLAT
26	37	PA022		5-1168	20418	BUSHING
26	38	PA022		5-1165	20418	TRAILING ARM SET



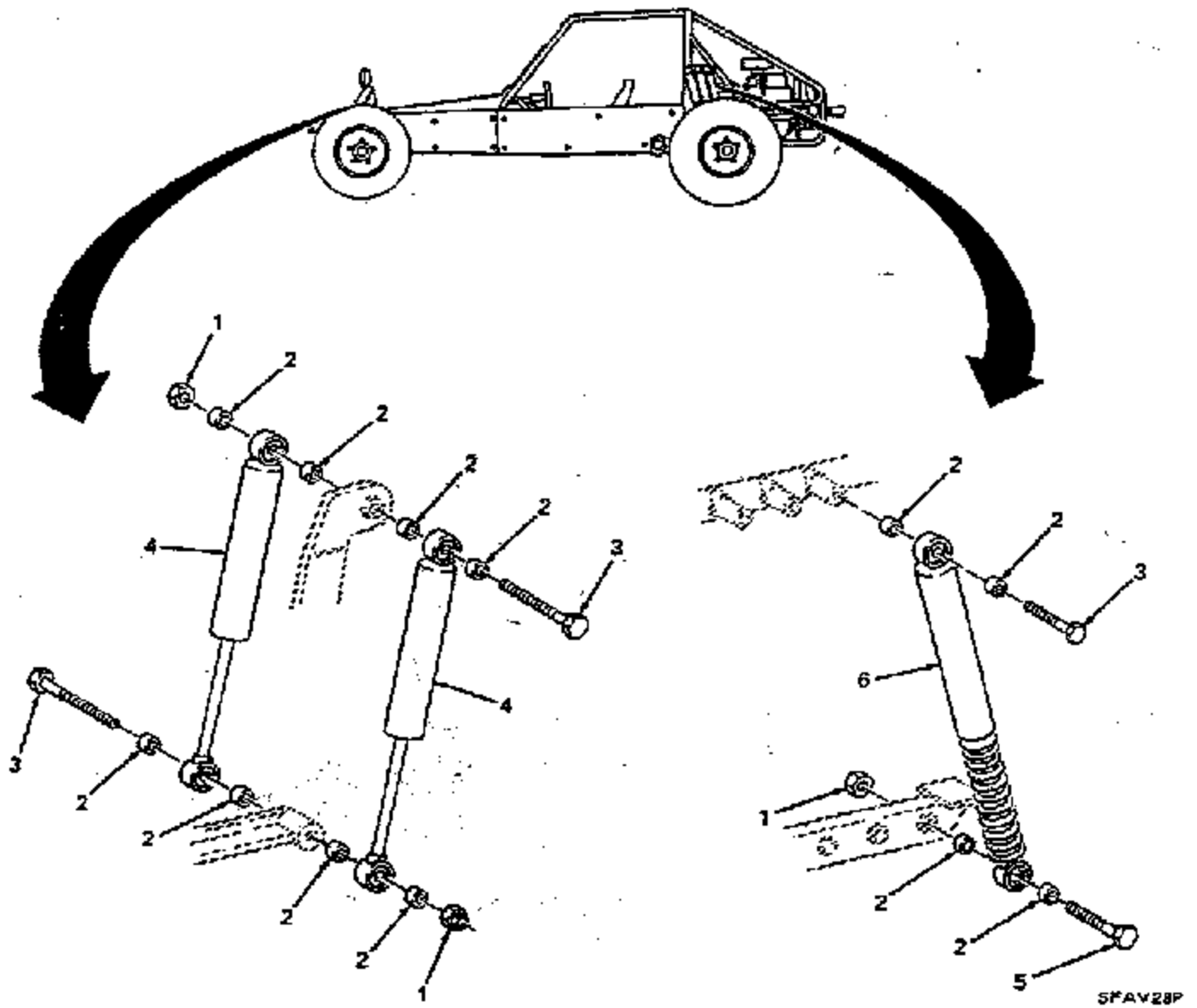
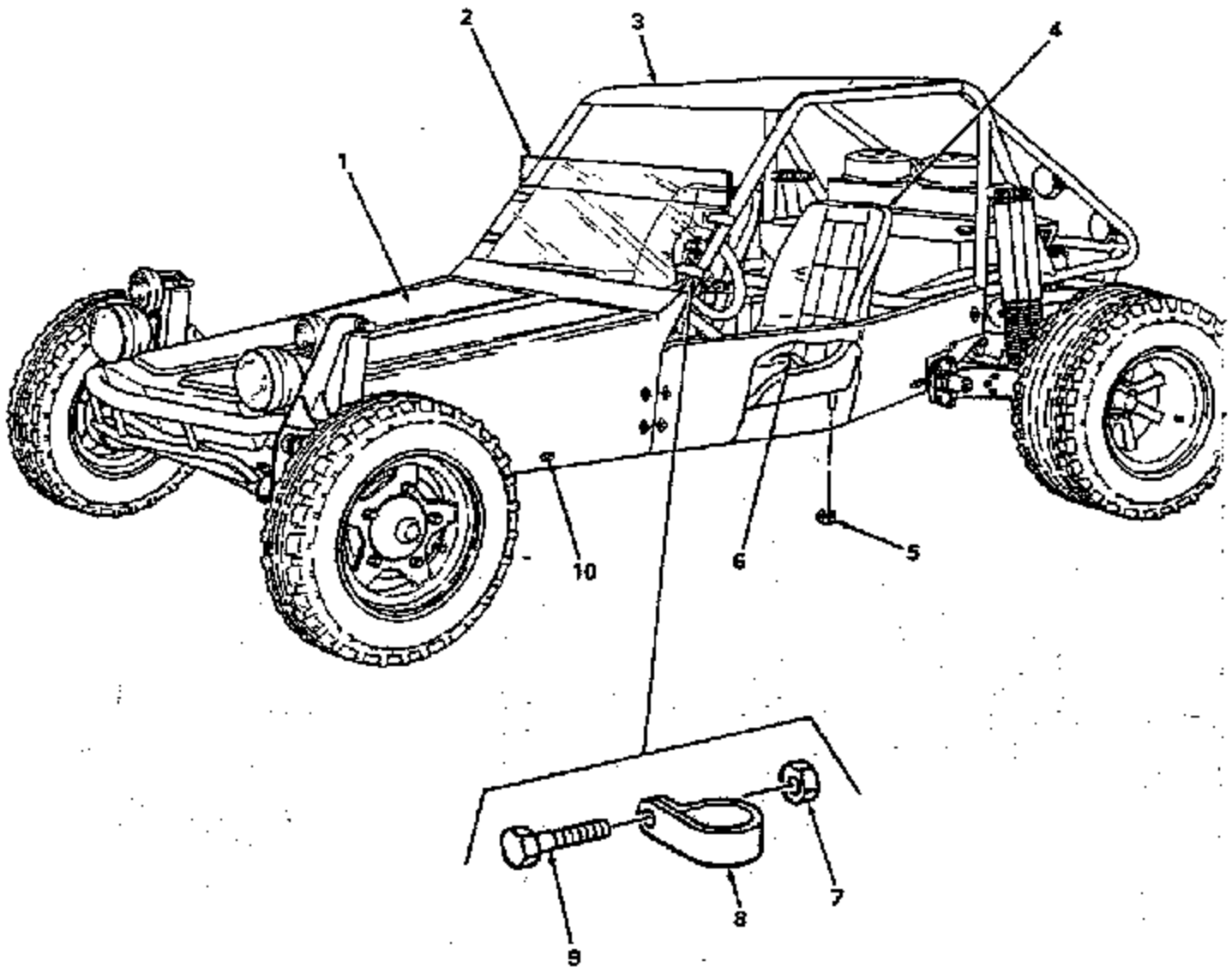

Figure 2-27. Shocks

(1) ILLUSTRATION		(2)	(3)	(4)	(5)	(6) DESCRIPTION
(a) FIG NO.	(b) ITEM NO.	SMR CODE	NATIONAL STOCK NUMBER	PART NUMBER	FSCM	USABLE ON CODE
27	1	PA022		COML	COML	GROUP 1604 - SHOCKS NUT, SELF-LOCKING: 12MM
27	2	PA022		COML	COML	SPACER: 12MM X 8MM
27	3	PA022		4-1155	20418	BOLT, MACHINE
27	4	PA022		4-1154	20418	SHOCK ABSORBER, FRONT
27	5	PA022		5-1336	20418	BOLT, MACHINE
27	6	PA022		5-1190	20418	SHOCK ABSORBER, REAR



SFAV29

Figure 2-28. Body Components

(1) ILLUSTRATION		(2)	(3)	(4)	(5)	(6) DESCRIPTION
(a) FIG NO.	(b) ITEM NO.	SNR CODE	NATIONAL STOCK NUMBER	PART NUMBER	FSCN	USABLE ON CELL
						GROUP 1501 - BODY COMPONENTS
28	1	PA022		9-1117	20418	BODY, FIBERGLASS
28	2	PA022		9-1120	20418	WINDSHIELD
28	3	PA022		9-1118	20418	ROOF, FIBERGLASS
28	4	PA022		9-1124	20418	SEAT, PERSONNEL
28	5	PA022		COML	COML	NUT, SELF-LOCKING: 5/16 - 18
28	6	PA022		9-1126	20418	BELT, PERSONNEL SAFETY
28	7	PA022		COML	COML	NUT, SELF-LOCKING
28	8	PA022		9-1121	20418	CLAMP, WINDSHIELD MOUNTING
28	9	PA022		COML	COML	BOLT, MACHINE
28	10	PA022		9-1119	20418	FASTENER, TURNLOCK

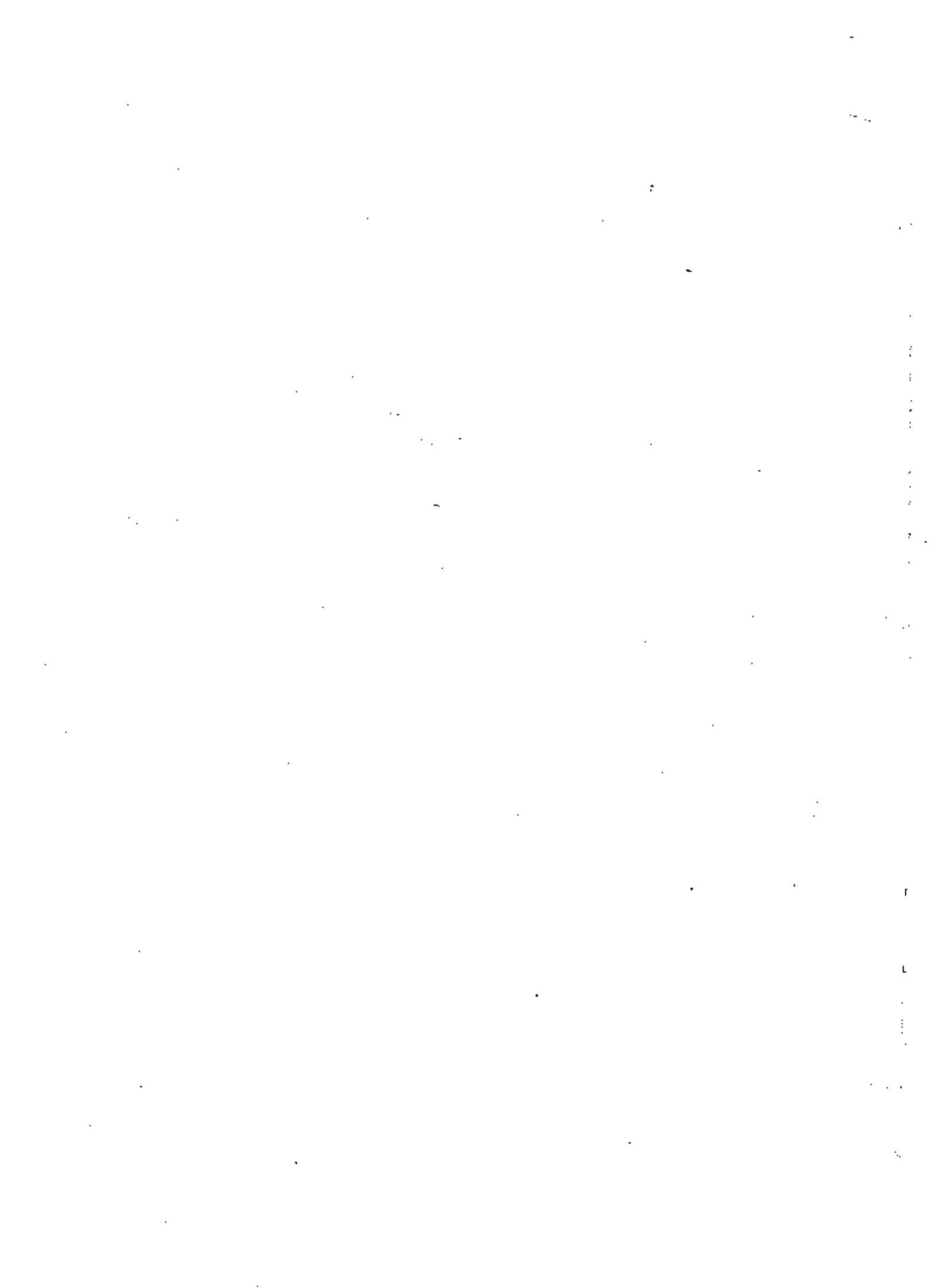

Section III. INDEX - PART NUMBER TO FIGURE AND ITEM NUMBER

PART NUMBER	FSCM	FIG NO.	ITEM NO.	PART NUMBER	FSCM	FIG NO.	ITEM NO.
NO. 44	20418	7	5	5-1165	20418	26	38
NO. 48	20418	7	11	5-1166	20418	19	27
1-1111	20418	1	7	5-1167	20418	19	12
1-1113	20418	5	6	5-1168	20418	26	27
1-1303	20418	5	9	5-1169	20418	19	17
1-1304	20418	5	11	5-1170	20418	23	1
1-1305	20418	6	3	5-1170	20418	19	27
1-1307	20418	13	3	5-1171	20418	19	17
1-1308	20418	13	4	5-1172	20418	19	17
1-1309	20418	13	5	5-1173	20418	19	18
1-1310	20418	13	9	5-1174	20418	19	14
1-1311	20418	13	10	5-1175	20418	19	16
1-1312	20418	2	12	5-1176	20418	19	10
1-1313	20418	6	4	5-1177	20418	26	13
1-1314	20418	2	10	5-1178	20418	26	19
1-1315	20418	13	2	5-1179	20418	26	17
1-1316	20418	13	1	5-1181	20418	26	18
1-1317	20418	1	1	5-1182	20418	26	19
1-1355	20418	2	11	5-1183	20418	26	18
1-1356	20418	10	10	5-1184	20418	26	17
1-1366	20418	10	6	5-1185	20418	26	17
1-1367	20418	10	5	5-1186	20418	26	17
1-1368	20418	10	9	5-1187	20418	26	17
1-1375	20418	13	12	5-1188	20418	26	18
1-1376	20418	13	11	5-1189	20418	26	18
1-1377	20418	13	7	5-1190	20418	27	6
1-1378	20418	13	8	5-1191	20418	19	5
1-1387	20418	5	10	5-1192	20418	19	9
1-1388	20418	13	6	5-1193	20418	19	1
3-1114	20418	17	6	5-1194	20418	19	5
4-1144	20418	26	9	5-1195	20418	19	2
4-1145	20418	26	8	5-1333	20418	23	9
4-1146	20418	25	9	5-1336	20418	27	5
4-1148	20418	25	12	5-1340	20418	19	3
4-1153	20418	26	5	5-1341	20418	26	29
4-1154	20418	27	4	5-1342	20418	26	24
4-1155	20418	27	3	5-1349	20418	19	4
4-1156	20418	26	3	5-1353	20418	19	10
4-1157	20418	26	4	5-1382	20418	19	11
4-1158	20418	25	15	5-1383	20418	26	26
4-1159	20418	25	7	5-1384	20418	26	25
4-1162	20418	25	3	5-1385	20418	26	27
4-1298	20418	25	10	6-1245	20418	22	27
4-1299	20418	25	11	6-1246	20418	22	4
4-1325	20418	23	6	6-1247	20418	22	5
4-1326	20418	23	4	6-1248	20418	22	6
4-1330	20418	11	3	6-1249	20418	22	7
4-1338	20418	23	2	6-1250	20418	22	12
1339	20418	23	1	6-1251	20418	22	14
1345	20418	25	8	6-1252	20418	22	13

PART NUMBER	FSCM	FIG NO.	ITEM NO.	PART NUMBER	FSCM	FIG NO.	ITEM NO.
6-1253	20418	22	18	8-1226	20418	14	5
6-1254	20418	22	19	8-1227	20418	14	1
6-1255	20418	22	9	8-1228	20418	14	4
6-1256	20418	22	11	8-1229	20418	2	14
6-1258	20418	23	7	8-1230	20418	14	3
6-1259	20418	21	6	8-1231	20418	12	2
6-1260	20418	21	7	8-1232	20418	15	1
6-1261	20418	21	9	8-1233	20418	14	8
6-1262	20418	21	4	8-1234	20418	15	5
6-1263	20418	21	3	8-1235	20418	15	3
6-1264	20418	22	1	8-1236	20418	14	7
6-1265	20418	21	14	8-1237	20418	14	13
6-1266	20418	21	8	8-1238	20418	16	6
6-1267	20418	21	2	8-1239	20418	16	3
6-1268	20418	21	1	8-1240	20418	16	7
6-1274	20418	22	2	8-1241	20418	16	4
6-1275	20418	22	3	8-1242	20418	16	5
6-1277	20418	23	10	8-1244	20418	14	11
6-1280	20418	22	20	8-1306	20418	11	14
6-1281	20418	21	5	8-1322	20418	15	2
6-1294	20418	22	16	8-1323	20418	15	6
6-1295	20418	20	3	8-1328	20418	8	2
6-1324	20418	22	24	8-1335	20418	14	6
6-1329	20418	22	17	8-1357	20418	14	9
6-1380	20418	22	15	8-1369	20418	11	4
7-1197	20418	4	3	8-1370	20418	11	2
7-1198	20418	4	11	8-1371	20418	11	1
7-1199	20418	9	8	8-1372	20418	11	9
7-1200	20418	9	5	8-1373	20418	11	12
7-1201	20418	9	1	8-1374	20418	11	10
7-1203	20418	9	4	8-1379	20418	15	6
7-1204	20418	18	4	8-1381	20418	19	7
7-1207	20418	18	7	8-1386	20418	2	13
7-1209	20418	18	5	9-1117	20418	28	1
7-1210	20418	18	6	9-1118	20418	28	3
7-1211	20418	18	8	9-1119	20418	28	10
7-1213	20418	18	10	9-1120	20418	28	2
7-1214	20418	18	9	9-1121	20418	28	8
7-1215	20418	24	1	9-1122	20418	26	30
7-1216	20418	24	4	9-1123	20418	26	10
7-1217	20418	24	3	9-1124	20418	28	4
7-1218	20418	24	6	9-1126	20418	28	6
7-1221	20418	24	5	9-1128	20418	26	34
7-1222	20418	24	2	9-1129	20418	26	33
7-1300	20418	3	5	9-1130	20418	8	4
7-1301	20418	3	4	9-1131	20418	8	6
7-1302	20418	3	1	9-1132	20418	8	5
7-1320	20418	4	10	9-1133	20418	8	1
7-1321	20418	4	12	9-1134	20418	8	7
8-1223	20418	14	2	9-1136	20418	7	2
8-1224	20418	14	12	9-1137	20418	7	10
8-1225	20418	14	10	9-1138	20418	7	12

PART NUMBER	FSCM	FIG NO.	ITEM NO.	PART NUMBER	FSCM	FIG NO.	ITEM NO.
9-1139	20418	2	1	9-1360	20418	2	6
9-1140	20418	2	9	9-1361	20418	5	3
9-1318	20418	7	4	9-1362	20418	5	4
9-1348	20418	5	2	9-1363	20418	5	5
9-1354	20418	8	3	9-1364	20418	5	1
9-1360	20418	2	4	9-1365	20418	7	3
9-1360	20418	2	5				